

**NOTICE!!**

**These documents have been scanned!**

**Do not place un-scanned documents beneath this notice!**

**Do not remove this notice from this file!**

GPO Jacket No. 560-102  
Print Order 61540  
Rise Business Services, LLC  
Job=AZ15 7/3/2019



Box Number= AZ15140



Claim Begin-End: AMC352160-AMC352160

**1 Initial Receipt**



AZ15140-6 AMC351599-AMC352455

# CLAIM INDEX

DATE PREPARED: June 22, 1999

LEAD AMC NUMBER: AMC 352160  
THRU  
ENDING AMC NUMBER: AMC

<u>AMC NUMBER</u>	<u>*CLOSURE DECISION</u>	<u>CLAIM NAME</u>	<u>LOCATORS OF RECORD</u>
AMC 352160		MUSTANG	PAUL CLARK

\*FOR BLM PURPOSES ONLY



UNITED STATES  
DEPARTMENT OF THE INTERIOR  
BUREAU OF LAND MANAGEMENT

RECEIPT AND ACCOUNTING ADVICE

NO. **2480316**  
CD/AZ 05/27/99

*Rec'd MC  
6-3-99*

Subject: LOCATION & SERVICE FEE (1) 2 1 11 25.00  
CLAIM MAINTENANCE FEE 1999 (1) 2 1 12 10.00  
Applicant: 2 1 13 100.00

PAUL CLARK  
PO BOX 4950  
MESA AZ 85211

CK 1011  
602 969 9807

Remitter:

*6/11/99 L*

Assignor:

*6/4/99 Jo*

LEASE MANAGEMENT DATA  NEW  UPDATE  PAYMENT

ORIGINAL SERIAL NO.	ASG.	TYPE	ST.	CTY.	FUND SYMBOL	ACRES/UNITS	RATE
AMC 352160							

AMOUNT	ANV. DATE	EXP. DATE	BILL CYC.	S/C	DISTRICT	NEXT BILL	MISC. DATA	U of M	ACTUAL UNITS

ASSIGNMENT SERIAL NO.	ASG.	TYPE	ST.	CTY.	FUND SYMBOL	ACRES/UNITS	RATE

AMOUNT	ANV. DATE	EXP. DATE	BILL CYC.	S/C	DISTRICT	NEXT BILL	MISC. DATA	U of M	ACTUAL UNITS

APPLY REMITTANCE

ACTION	FUND SYMBOL	CTY.	AMOUNT
FILING FEE			
RENTAL			
UNEARNED			
REFUND			
TOTAL			
AMOUNT DUE			

Remarks:

BY:

DATE:

- Lease in Escrow?
- KGS? Of Interest?
- Auto Escalates? Operating Rights?
- Auto Renew? Operator
- Bond Filed?

FOR MMS USE ONLY

BILLEE	FOREST REFUGE
NUMBER	
OCS SECTION	
CODE	



**NOTICE!!**

**These documents have been scanned!**

**Do not place un-scanned documents beneath this notice!**

**Do not remove this notice from this file!**

GPO Jacket No. 560-102  
Print Order 61540  
Rise Business Services, LLC  
Job=AZ15 7/3/2019



Box Number= AZ15140



Claim Begin-End: AMC352160-AMC352160

**2 Correspondence**



AZ15140-6

AMC351599-AMC352455

**NO  
DOCUMENTS  
FOUND**

NO DOCUMENTS FOUND  
NO DOCUMENTS FOUND



**NOTICE!!**

**These documents have been scanned!**

**Do not place un-scanned documents beneath this notice!**

**Do not remove this notice from this file!**

GPO Jacket No. 560-102  
Print Order 61540  
Rise Business Services, LLC  
Job=AZ15 7/3/2019



Box Number= AZ15140



Claim Begin-End: AMC352160-AMC352160

**3 Transfers**



AZ15140-6

AMC351599-AMC352455

352160  
339303

COPY

QUIT CLAIM DEED

FOR VALUABLE CONSIDERATION, the sufficiency and receipt of which is hereby acknowledged,  
BILL C. WALDECK does hereby forever quit claim <sup>50% OF</sup> ~~at~~ his right, title and interest in  
the unpatented mining claims described on the supplemental attachment, attached hereto and incorporated  
herein by reference, to TRUDY E. MOVICH.

IN WITNESS WHEREOF, grantor has executed this instrument as of this 23 day of OCTOBER, 20 18

Bill C. Waldeck

Exempt from A.R.S. 11-1133 and 11-1137(B) by A.R.S. 11-1134(A)(6)

RECEIVED  
DLM AZ STATE OFFICE  
2018 OCT 29 P 3:00  
PHOENIX, ARIZONA

STATE OF ARIZONA )  
County of Yavapai ) ss.

SUBSCRIBED AND SWORN TO before me, a Notary Public, this 23rd day of October, 20 18

By: Rebecca Hernandez

Notary Public Rebecca Hernandez

My Commission Expires 2-13-2019

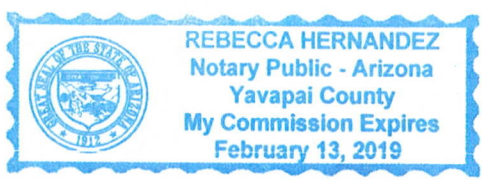

Form MCF120  
Revised July 2014

This form is available from the Arizona Geological Survey and may be reproduced.

ENTERED  
DEC 19 2018  
BY: RAM

#4294970

Supplemental Attachment to Quit Claim Deed

I, Bill C. Waldeck, do hereby transfer fifty percent (50%) ownership of the lode mining claim filed as:

**Mustang, AMC #352160, T8N, R1W, Sec 3, located in Yavapai County Arizona,**  
to Trudy E. Movich of P.O. Box 566, Rimrock, AZ 86335.

Bill C. Waldeck  
P.O. Box 566  
Rimrock, AZ 86335

*Bill C. Waldeck*

Trudy E. Movich  
P.O. Box 566  
Rimrock, AZ 86335

*Trudy E. Movich*

RECEIVED  
BLM AZ STATE OFFICE  
2010 OCT 29 P 3:03  
PHOENIX, ARIZONA

ENTERED  
DEC 1 2 2010  
BY:



**QUIT CLAIM DEED**

FOR VALUABLE CONSIDERATION, the sufficiency and receipt of which is hereby acknowledged, TRUDY E. MOVICH does hereby forever quit claim <sup>50% OF HER</sup> ~~all his~~ right, title and interest in the unpatented mining claims described on the supplemental attachment, attached hereto and incorporated herein by reference, to BILL C. WALDECK.

IN WITNESS WHEREOF, grantor has executed this instrument as of this 23<sup>rd</sup> day of October, 20 18

Trudy Movich

Exempt from A.R.S. 11-1133 and 11-1137(B) by A.R.S. 11-1134(A)(6)

STATE OF ARIZONA )  
County of Yavapai ) ss.

RECEIVED  
BLM AZ STATE OFFICE  
2018 OCT 29 P 3:05  
PHOENIX, ARIZONA

**SUBSCRIBED AND SWORN TO** before me, a Notary Public, this 23<sup>rd</sup> day of October, 20 18

By: Rebecca Hernandez

Notary Public Rebecca Hernandez

My Commission Expires 2-13-2019

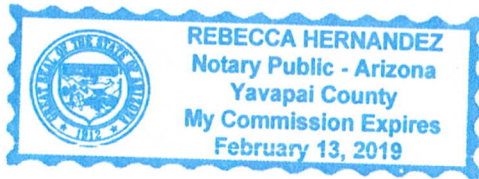

Supplemental Attachment to Quit Claim Deed

I, Trudy E. Movich, do hereby transfer fifty percent (50%) ownership of the lode mining claim filed as:

**Lower Flats #1, AMC #339303, T8N, R1W, Sec 11, Located in Yavapai County, Arizona,**  
to Bill C. Waldeck of P.O. Box 566, Rimrock, AZ 86335.

Trudy E. Movich  
P.O. Box 566  
Rimrock, AZ 86335



Bill C. Waldeck  
P.O. Box 566  
Rimrock, AZ 86335

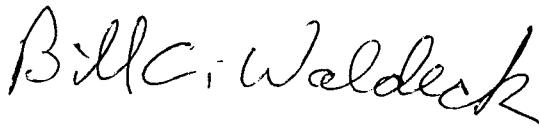

RECEIVED  
BLM AZ STATE OFFICE  
2010 OCT 29 P 3:05  
PHOENIX, ARIZONA

Arizona Natural Gold  
Excavation & Reclamation, Inc  
P.O. Box 566  
Rimrock, AZ 86335

PHOENIX AZ 852

25 OCT 2018 PM 3 L



PHOENIX, ARIZONA

2018 OCT 29 P 3:04

RECEIVED  
BLM AZ STATE OFFICE

Bureau of Land Management  
Dept of the Interior  
Attn: Public Room  
One N. Central Avenue  
Phoenix, Az 85004-4427

8500484414 C041





**United States Department of the Interior**  
**Bureau of Land Management**  
 DIV OF LANDS, MINRLS & ENERGY  
 ONE N CENTRAL AVE  
 PHOENIX, AZ 85004 -4427  
 Phone: 602-417-9200

Receipt

No: 4294970

<b>Transaction #:</b> 4411111	
<b>Date of Transaction:</b> 10/30/2018	
CUSTOMER:	
ARIZONA NATURAL GOLD EXCAVATION PO BOX 566 RIMROCK, AZ 86335-0566 US	

LINE #	QTY	DESCRIPTION	REMARKS	UNIT PRICE	TOTAL
1	1.00	LOCATABLE MINERALS / MINING CLAIMS- NOT NEW-UNADJUD, ONE AUTH NO. ONLY / MINING CLAIM MONEY RECEIVED CASES: AMC352160/\$20.00	TRF/2	- n/a -	20.00
<b>TOTAL:</b>					<b>\$20.00</b>

PAYMENT INFORMATION			
1	AMOUNT:	20.00	POSTMARKED: N/A
	TYPE:	CHECK	RECEIVED: 10/29/2018
	CHECK NO:	2638	
	NAME:	ARIZONA NATURAL GOLD EXCAVATION PO BOX 566 RIMROCK AZ 86335-0566 US	

<b>REMARKS</b>
THERE HAS BEEN A FEE INCREASE / PLEASE REVIEW FLYER.

This receipt was generated by the automated BLM Collections and Billing System and is a paper representation of a portion of the official electronic record contained therein.

*\$15.00 USED FOR TRF ON AMC 352160.*  
*\$5.00 USED ON AMC ~~339303~~ 339303. USED #10 FROM RCPT # 4334042. FOR \$15.00 TOTAL. LJM*

Login ID6222

Entry Date12/20/2018

Total Amount\$5.00

**Original Order Items**

Line	Order#	AuthNos	TransDate	Action	Amount	CostCtr	R Org	BPD Year	Fund	FunctArea	WBS	Receipt Reference	CBS Bill#	Type	OrderItem
1	4411111	AMC352160 ▼	10/30/2018	MINING CLAIM MONEY RECEIVED	\$20.00	LLAZ920000	LLAZ920000	2019	XXXL6500DP	L01130000.000000				C	8900610

**Order Items To Be Generated for Transfer**

Line	Order#	AuthNos	TransDate	Action	Amount	CostCtr	R Org	BPD Year	Fund	FunctArea	WBS	Receipt Reference	CBS Bill#	Type	OrderItem
1	4411111	AMC352160 ▼	12/20/2018	MINING CLAIM MONEY RECEIVED	\$-5.00	LLAZ920000	LLAZ920000	2019	XXXL6500DP	L01130000.000000				T	0
2	4411111	AMC339303 ▼	12/20/2018	TRANSFER OF INTEREST SVC CHG	\$5.00	LLAZ920000	LLAZ920000	2019	19XL1109ML	L19300000.RB0000				T	0



# United States Department of the Interior

BUREAU OF LAND MANAGEMENT  
Arizona State Office  
One North Central Avenue, Suite 800  
Phoenix, Arizona 85004-4427  
www.blm.gov/az/



## NOTICE

### Additional Processing Fees Required

The Arizona State Office, Bureau of Land Management, received your conveyance document to transfer interest in your mining claims.

Due to a processing fee increase effective October 1, 2018, we did not receive sufficient fees with your document. The fee increased from \$10 per mining claim, per grantee, to \$15 per mining claim, per grantee. Please mail in the amount shown below or call our public room at 602-417-9200 to pay with a credit card over the phone. Address your payment to the Attention of Robert Mattson. We cannot process your documents until we receive the additional fees.

Please include your Arizona Mining Claim (AMC) serial number(s) and claim name(s) when submitting the additional fees and let us know it is to pay the additional fees for your transfer document. If additional information is required, please contact Robert Mattson at 602-417-9565.

Additional amount due: \$10.00 \$5.00 Per GRANTEE

### TRANSFER DOCUMENTS FOR:

TRANSFER 50% TO TRUDY MOVICH	AMC 352160	MUSTANG	\$5.00	ADDITIONAL NEEDED
TRANSFER 50% TO BILL WALDECK	AMC 339303	LOWER FLATS#1	\$5.00	ADDITIONAL NEEDED
		CHECK#	\$10.00	ATTACHED

RECEIVED  
BLM AZ STATE OFFICE  
2018 DEC 13 P 2:53  
PHOENIX, ARIZONA





Trudy Morick  
P.O. Box 566  
Rimrock, AZ 86335

PHOENIX AZ 852

12 DEC 2018 PM 6 L



Bureau of Land Management  
Arizona State Office  
ATTN: Robert Mattson  
One North Central Avenue, Suite 800  
Phoenix, AZ 85004-4427

PHOENIX, ARIZONA

2018 DEC 13 P 2:53

RECEIVED  
BLM AZ STATE OFFICE

85004-442700



Login ID6222

Entry Date02/05/2019

Total Amount\$10.00

## Original Order Items

Line	Order#	AuthNos	TransDate	Action	Amount	CostCtr	R Org	BPD Year	Fund	FunctArea	WBS	Receipt Reference	CBS Bill#	Type	OrderItem
1	4450767	AMC352160 ▾	12/14/2018	MINING CLAIM MONEY RECEIVED	\$10.00	LLAZ920000	LLAZ920000	2019	XXXL6500DP	L01130000.000000				C	8962594

## Order Items To Be Generated for Transfer

Line	Order#	AuthNos	TransDate	Action	Amount	CostCtr	R Org	BPD Year	Fund	FunctArea	WBS	Receipt Reference	CBS Bill#	Type	OrderItem
1	4450767	AMC352160 ▾	2/5/2019	MINING CLAIM MONEY RECEIVED	\$-10.00	LLAZ920000	LLAZ920000	2019	XXXL6500DP	L01130000.000000				T	0
2	4450767	▾	2/5/2019	NONREFUNDABLE PROCESSING FEE	\$10.00	LLAZ920000	LLAZ920000	2019	19XL1109ML	L19300000.RB0000				T	0

**United States Department of the Interior**  
**Bureau of Land Management**  
 DIV OF LANDS, MINRLS & ENERGY  
 ONE N CENTRAL AVE  
 PHOENIX, AZ 85004 -4427  
 Phone: 602-417-9200

Receipt

No: 4334042

<b>Transaction #:</b> 4450767	
<b>Date of Transaction:</b> 12/14/2018	
CUSTOMER:	
ARIZONA NATURAL GOLD EXCAVATION PO BOX 566 RIMROCK, AZ 86335-0566 US	

LINE #	QTY	DESCRIPTION	REMARKS	UNIT PRICE	TOTAL
1	1.00	LOCATABLE MINERALS / MINING CLAIMS-NOT NEW-UNADJUD, ONE AUTH NO. ONLY / MINING CLAIM MONEY RECEIVED CASES: AMC352160/\$10.00	ADDITIONAL FEES	- n/a -	10.00
<b>TOTAL:</b>					<b>\$10.00</b>

PAYMENT INFORMATION			
1	AMOUNT:	10.00	POSTMARKED: N/A
	TYPE:	CHECK	RECEIVED: 12/13/2018
	CHECK NO:	2648	
	NAME:	ARIZONA NATURAL GOLD EXCAVATION PO BOX 566 RIMROCK AZ 86335-0566 US	

REMARKS
ADDITIONAL FEES

This receipt was generated by the automated BLM Collections and Billing System and is a paper representation of a portion of the official electronic record contained therein.

*\$ 10.00 FROM THIS RCPT PLUS  
 \$ 5.00 FROM RCPT # 4294970 USED  
 FOR TRANSFER ON AMC339303. PM*

AMC 352160

QUIT CLAIM DEED

For Valuable consideration, the sufficiency and receipt of which is hereby acknowledged

x Paul CLARK does hereby forever quit claim all his/her right, print

title and interest in the unpatented mining claims described on the supplemental attachment, attached hereto and incorporated herein by reference,

to Bill C Waldeck.

Sum of \$4000.00

IN WITNESS WHEREOF, grantor has executed this instrument as of this 21 day of Aug 2018

x Paul Clark  
sign

Exempt from A.R.S. 11-1133 and 11-1137 (B) by A.R.S. 11-1134 (A) (6)

STATE OF ARIZONA )  
) SS.

County of Yavapai

SUBSCRIBED AND SWORN TO before me, a Notary Public, this 21 day of Aug 2018

By. Paul Clark

Notary Public Brianna Barksdale

My Commission Expires Jan 29 2022

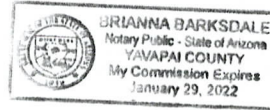

RECEIVED  
AZ STATE OFFICE  
2018 AUG 29 P 1:14  
PHOENIX, ARIZONA

ENTERED  
AUG 30 2018  
BY: BKS

Supplemental ATT;

This Claim was sold to the below.

Seller

Paul Clark

P.O. Box 1308

Congress Az, 85332

Buyer

Bill C Waldeck

P.O. Box 566

Rimrock Arizona, 86335

AMC 352160

Mustang

T8N R1W SEC, 3 Mer, Gila-Salt River

This is a 20 acre Lode Claim.

Mail receipt to.

Bill C Waldeck

P.O. Box 566

Rimrock Az, 86335

PHOENIX, ARIZONA

2010 AUG 29 P 1:14

RECEIVED  
MINN AZ STATE OFFICE

**United States Department of the Interior**  
**Bureau of Land Management**  
 DIV OF LANDS, MINRLS & ENERGY  
 ONE N CENTRAL AVE  
 PHOENIX, AZ 85004 -4427  
 Phone: 602-417-9200

Receipt

No: 4248949

<b>Transaction #:</b> 4364434	
<b>Date of Transaction:</b> 08/29/2018	
<b>CUSTOMER:</b>	
BILL C WALDECK PO BOX 566 RIMROCK, AZ 86335-0566 US	

LINE #	QTY	DESCRIPTION	REMARKS	UNIT PRICE	TOTAL
1	1.00	LOCATABLE MINERALS / MINING CLAIMS-NOT NEW-UNADJUD, ONE AUTH NO. ONLY / MINING CLAIM MONEY RECEIVED CASES: AMC352160/\$10.00	QUIT CLAIM/1	- n/a -	10.00
<b>TOTAL:</b>					<b>\$10.00</b>

PAYMENT INFORMATION				
NOTE: Items will appear on credit card statement as "Bureau of Land Mgmt CO".				
1	AMOUNT:	10.00	POSTMARKED:	N/A
	TYPE:	CREDIT CARD	RECEIVED:	08/29/2018
	NAME:	WALDECK, BILL C PO BOX 566 RIMROCK AZ 86335-0566 US		
	CARD NO:	XXXXXXXXXXXX0722	AUTH CODE:	122735
	NAME ON CARD:	BILL C WALDECK		
	SIGNATURE:			

REMARKS

This receipt was generated by the automated BLM Collections and Billing System and is a paper representation of a portion of the official electronic record contained therein.



**NOTICE!!**

**These documents have been scanned!**

**Do not place un-scanned documents beneath this notice!**

**Do not remove this notice from this file!**

GPO Jacket No. 560-102  
Print Order 61540  
Rise Business Services, LLC  
Job=AZ15 7/3/2019



Box Number= AZ15140



Claim Begin-End: AMC352160-AMC352160

**4 Annual Filings**



AZ15140-6

AMC351599-AMC352455

UNITED STATES  
DEPARTMENT OF THE INTERIOR  
BUREAU OF LAND MANAGEMENT

155  
*[Handwritten signature]*

352160

**MAINTENANCE FEE WAIVER CERTIFICATION**

FORM APPROVED  
OMB NO. 1004-0114  
Expires: January 31, 2020

SEE INSTRUCTIONS ON PAGE 2

1. This small miner waiver is filed for the assessment year beginning on September 1, 2019 and ending on September 1, 2020.
2. The undersigned and all related parties owned ten or fewer mining claims, mill, or tunnel sites located and maintained on Federal lands in the United States of America on September 1, 2019.
3. The undersigned have performed the assessment work required by law for each mining claim listed prior to filing this waiver and understand that by filing this form, the undersigned must file an affidavit of assessment work with the Bureau of Land Management (BLM) by the December 30th following the filing of this waiver.
4. The undersigned understand that if the assessment work obligation has not yet come due under 30 U.S.C. 28 (for those claims in their first assessment year only), a notice of intent to hold reciting this condition must be recorded by the December 30th following the filing of this waiver.
5. The undersigned understand that mill and tunnel sites may also be listed on this waiver and be waived from payment of the maintenance fee, and that a notice of intent to hold for these sites is required to be filed with the BLM by the December 30th following the filing of this waiver.
6. The undersigned understand and acknowledge that pursuant to 43 U.S.C. 1212 and 18 U.S.C. 1001, the filing or recording of a false, fictitious, or fraudulent document with the BLM may result in a fine of up to \$250,000, a prison term not to exceed five years, or both.
7. The mining claims, mill or tunnel sites for which this waiver from payment of the maintenance fees is requested are:

CLAIM OR SITE NAME	BLM RECORDATION SERIAL NUMBER
1. <u>MUSTANG</u>	<u>352160</u>
2.	
3.	
4.	
5.	
6.	
7.	
8.	
9.	
10.	

The owner(s) (claimants) of the above mining claims and sites are:

BILL WALDECK  
(Owner's Name - Please Print)

P.O. Box 566  
(Owner's Mailing Address)

Bill Waldeck  
(Owner's Signature)

RIMROCK AZ 86335  
(City) (State) (Zip Code)

TRUDY MOVICH  
(Owner's Name - Please Print)

P.O. Box 566  
(Owner's Mailing Address)

Trudy Movich  
(Owner's Signature)

RIMROCK AZ 86335  
(City) (State) (Zip Code)

(Owner's Name - Please Print)

(Owner's Mailing Address)

(Owner's Signature)

(City)

(State)

(Zip Code)

(Owner's Name - Please Print)

(Owner's Mailing Address)

(Owner's Signature)

(City)

(State)

(Zip Code)

(Continued on page 2)

ENTERED  
SEP 14 2019  
BY: *[Signature]*

PHOENIX  
RIZONA  
AUG 14 PM 3:41  
RECEIVED  
STATE OFFICE

*[Handwritten signature]*

_____ (Owner's Name - Please Print)	_____ (Owner's Signature)		
_____ (Owner's Mailing Address)	_____ (City)	_____ (State)	_____ (Zip Code)
-----			
_____ (Owner's Name - Please Print)	_____ (Owner's Signature)		
_____ (Owner's Mailing Address)	_____ (City)	_____ (State)	_____ (Zip Code)
-----			
_____ (Owner's Name - Please Print)	_____ (Owner's Signature)		
_____ (Owner's Mailing Address)	_____ (City)	_____ (State)	_____ (Zip Code)
-----			
_____ (Owner's Name - Please Print)	_____ (Owner's Signature)		
_____ (Owner's Mailing Address)	_____ (City)	_____ (State)	_____ (Zip Code)

18 U.S.C. 1001 and 43 U.S.C. 1212 make it a crime for any person knowingly and willfully to make to any department or agency of the United States any false, fictitious or fraudulent statements or representations as to any matter within its jurisdiction.

INSTRUCTIONS

1. This certification is made under the provisions of 43 U.S.C. § 1744 and 30 U.S.C. §28-28k and the regulations thereunder (43 CFR Part 3830).
2. The claimant(s) must fill in the dates in paragraph 1 for the beginning and ending of the assessment year for which this waiver is sought.
3. The claimant(s) must fill in the date in paragraph 2 for the beginning of the assessment year for which this waiver is sought.
4. All claim and site names and BLM serial numbers must be listed for the mining claims, mill sites, and tunnel sites for which the waiver is sought.
5. All owners of the mining claims, mill sites, and tunnel sites and their addresses must be given.
6. This waiver form must be signed by all the claimants or their designated agent, in original form. If an agent is designated, a notarized designation of agent, signed by all of the claimants with proper address given, must be submitted with this waiver.
7. This form must be filed no later than September 1st for the upcoming assessment year in the BLM State Office where the mining claims or sites are recorded, or the waiver cannot be granted by the BLM. (Example: To obtain a waiver for the assessment year 2012, which begins on September 1, 2011, you must qualify for and file for a waiver no later than September 1, 2011, in the proper BLM State Office.)
8. For all mining claims which require assessment work, you must record an affidavit of labor on or before the December 30th immediately following the filing of this waiver. For all other mining claims or sites waived, you must record a notice of intent to hold on or before the December 30th immediately following the filing of this waiver.
9. Mill and tunnel sites may also be listed on this waiver and be waived from payment of the maintenance fee. A notice of intent to hold for these sites is required to be filed by the December 30th following the filing of this waiver.

PHOENIX, ARIZONA  
 2019 AUG 14 P 12:34  
 RECEIVED  
 STATE OFFICE

FOR OFFICIAL USE ONLY



UNITED STATES  
DEPARTMENT OF THE INTERIOR  
BUREAU OF LAND MANAGEMENT  
**MAINTENANCE FEE WAIVER CERTIFICATION**

FORM APPROVED  
OMB NO. 1004-0114  
Expires: January 31, 2020

SEE INSTRUCTIONS ON PAGE 2

AMC 352160

Attach to A 430  
PER [Signature]

- This small miner waiver is filed for the assessment year beginning on September 1, 2018 and ending on September 1, 2019
- The undersigned and all related parties owned ten or fewer mining claims, mill, or tunnel sites located and maintained on Federal lands in the United States of America on September 1, 2018
- The undersigned have performed the assessment work required by law for each mining claim listed prior to filing this waiver and understand that by filing this form, the undersigned must file an affidavit of assessment work with the Bureau of Land Management (BLM) by the December 30th following the filing of this waiver.
- The undersigned understand that if the assessment work obligation has not yet come due under 30 U.S.C. 28 (for those claims in their first assessment year only), a notice of intent to hold reciting this condition must be recorded by the December 30th following the filing of this waiver.
- The undersigned understand that mill and tunnel sites may also be listed on this waiver and be waived from payment of the maintenance fee, and that a notice of intent to hold for these sites is required to be filed with the BLM by the December 30th following the filing of this waiver.
- The undersigned understand and acknowledge that pursuant to 43 U.S.C. 1212 and 18 U.S.C. 1001, the filing or recording of a false, fictitious, or fraudulent document with the BLM may result in a fine of up to \$250,000, a prison term not to exceed five years, or both.
- The mining claims, mill or tunnel sites for which this waiver from payment of the maintenance fees is requested are:

CLAIM OR SITE NAME	BLM RECORDATION SERIAL NUMBER
1. MUSTANG	AMC 352160
2.	
3.	
4.	
5.	
6.	
7.	
8.	
9.	
10.	

RECEIVED  
BLM AZ STATE OFFICE  
2018 SEP 20 P 2:55  
PHOENIX, ARIZONA

The owner(s) (claimants) of the above mining claims and sites are:

<sup>nd</sup> BILL WALDECK  
(Owner's Name - Please Print)  
P.O. BOX 566  
(Owner's Mailing Address)

Bill Waldock  
(Owner's Signature)  
Rimrock AZ 86335  
(City) (State) (Zip Code)

RECEIVED  
BLM AZ STATE OFFICE  
2018 AUG 29 P 1:23  
PHOENIX, ARIZONA

(Owner's Name - Please Print)  
(Owner's Mailing Address)

(Owner's Signature)  
(City) (State) (Zip Code)

(Owner's Name - Please Print)  
(Owner's Mailing Address)

(Owner's Signature)  
(City) (State) (Zip Code)

(Owner's Name - Please Print)  
(Owner's Mailing Address)

(Owner's Signature)  
(City) (State) (Zip Code)

AL 247-REMOVED - THIS ORIGINAL WVR WAS RETURNED TO OUR OFFICE BY RB 2019 WVR - CURED  
ENTERED SEP 24 2018

4/4/18

(Owner's Name - Please Print)	(Owner's Signature)
(Owner's Mailing Address)	(City) (State) (Zip Code)
(Owner's Name - Please Print)	(Owner's Signature)
(Owner's Mailing Address)	(City) (State) (Zip Code)
(Owner's Name - Please Print)	(Owner's Signature)
(Owner's Mailing Address)	(City) (State) (Zip Code)
(Owner's Name - Please Print)	(Owner's Signature)
(Owner's Mailing Address)	(City) (State) (Zip Code)

18 U.S.C. 1001 and 43 U.S.C. 1212 make it a crime for any person knowingly and willfully to make to any department or agency of the United States any false, fictitious or fraudulent statements or representations as to any matter within its jurisdiction.

**INSTRUCTIONS**

1. This certification is made under the provisions of 43 U.S.C. § 1744 and 30 U.S.C. §28-28k and the regulations thereunder (43 CFR Part 3830).
2. The claimant(s) must fill in the dates in paragraph 1 for the beginning and ending of the assessment year for which this waiver is sought.
3. The claimant(s) must fill in the date in paragraph 2 for the beginning of the assessment year for which this waiver is sought.
4. All claim and site names and BLM serial numbers must be listed for the mining claims, mill sites, and tunnel sites for which the waiver is sought.
5. All owners of the mining claims, mill sites, and tunnel sites and their addresses must be given.
6. This waiver form must be signed by all the claimants or their designated agent, in original form. If an agent is designated, a notarized designation of agent, signed by all of the claimants with proper address given, must be submitted with this waiver.
7. This form must be filed no later than September 1st for the upcoming assessment year in the BLM State Office where the mining claims or sites are recorded, or the waiver cannot be granted by the BLM. (Example: To obtain a waiver for the assessment year 2012, which begins on September 1, 2011, you must qualify for and file for a waiver no later than September 1, 2011, in the proper BLM State Office.)
8. For all mining claims which require assessment work, you must record an affidavit of labor on or before the December 30th immediately following the filing of this waiver. For all other mining claims or sites waived, you must record a notice of intent to hold on or before the December 30th immediately following the filing of this waiver.
9. Mill and tunnel sites may also be listed on this waiver and be waived from payment of the maintenance fee. A notice of intent to hold for these sites is required to be filed by the December 30th following the filing of this waiver.

**FOR OFFICIAL USE ONLY**

W

Bill Waldeck  
P.O. Box 566  
Rimrock, AZ 86335

PHOENIX AZ 852

20 SEP 2018 PM 11 1

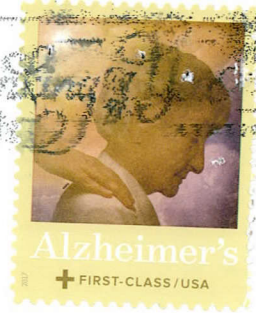

RECEIVED  
BLM AZ STATE OFFICE  
2018 SEP 20 P 2:30  
PHOENIX, ARIZONA

Pauline BROWN  
LAND LAW EXAMINER  
BLM  
AZ STATE office  
ONE NORTH CENTRAL AVE  
Suite 800  
PHOENIX, AZ 85004-4427

85004-442700





9/12/2018

BILL WALDECK  
PO BOX 566  
RIMROCK, AZ 86335-0566

Sir,

- It appears that our office mailed the Original 2019 Waiver back to you.
- The waiver was received in our office on Aug 29, 2018 (**date stamp in blue ink**).
- Please return the Original 2019 Waiver to our office.
- We **must** have the Original back in order for you to receive credit for the waiver.

If you have any questions, please call Pauline Brown at 602-417-9360.

Regards,

PAULINE BROWN  
LAND LAW EXAMINER  
BUREAU OF LAND MANAGEMENT  
ARIZONA STATE OFFICE  
ONE NORTH CENTRAL AVE, STE 800  
PHOENIX, AZ 85004-4427  
OFFICE: (602) 417-9360  
FAX: (602) 417-9490  
[paulinebrown@blm.gov](mailto:paulinebrown@blm.gov)  
[www.blm.gov/az](http://www.blm.gov/az)  
<https://www.facebook.com/BLMArizona>

RECEIVED  
BLM AZ STATE OFFICE  
2018 SEP 20 P 2:36  
PHOENIX, ARIZONA

UNITED STATES  
DEPARTMENT OF THE INTERIOR  
BUREAU OF LAND MANAGEMENT

**MAINTENANCE FEE WAIVER CERTIFICATION**

SEE INSTRUCTIONS ON PAGE 2

FORM APPROVED  
OMB NO. 1004-0114  
Expires: January 31, 2020

430

PER

352160

1. This small miner waiver is filed for the assessment year beginning on September 1, 2018 and ending on September 1, 2019
2. The undersigned and all related parties owned ten or fewer mining claims, mill, or tunnel sites located and maintained on Federal lands in the United States of America on September 1, 2018
3. The undersigned have performed the assessment work required by law for each mining claim listed prior to filing this waiver and understand that by filing this form, the undersigned must file an affidavit of assessment work with the Bureau of Land Management (BLM) by the December 30th following the filing of this waiver.
4. The undersigned understand that if the assessment work obligation has not yet come due under 30 U.S.C. 28 (for those claims in their first assessment year only), a notice of intent to hold reciting this condition must be recorded by the December 30th following the filing of this waiver.
5. The undersigned understand that mill and tunnel sites may also be listed on this waiver and be waived from payment of the maintenance fee, and that a notice of intent to hold for these sites is required to be filed with the BLM by the December 30th following the filing of this waiver.
6. The undersigned understand and acknowledge that pursuant to 43 U.S.C. 1212 and 18 U.S.C. 1001, the filing or recording of a false, fictitious, or fraudulent document with the BLM may result in a fine of up to \$250,000, a prison term not to exceed five years, or both.
7. The mining claims, mill or tunnel sites for which this waiver from payment of the maintenance fees is requested are:

CLAIM OR SITE NAME	BLM RECORDATION SERIAL NUMBER
1. MUSTANG	AMC 352160 (913)
2.	
3.	
4.	
5.	
6.	
7.	
8.	
9.	
10.	

The owner(s) (claimants) of the above mining claims and sites are:

7<sup>th</sup> BILL WALDECK  
 (Owner's Name - Please Print)  
 P.O. BOX 566  
 (Owner's Mailing Address)

Bill Waldock  
 (Owner's Signature)  
 RIMROCK AZ 86335  
 (City) (State) (Zip Code)

(Owner's Name - Please Print)  
 (Owner's Mailing Address)

(Owner's Signature)  
 (City) (State) (Zip Code)

(Owner's Name - Please Print)  
 (Owner's Mailing Address)

(Owner's Signature)  
 (City) (State) (Zip Code)

(Owner's Name - Please Print)  
 (Owner's Mailing Address)

(Owner's Signature)  
 (City) (State) (Zip Code)

AC483 (City)  
 ENTERED SEP-12-2018

AC247 - WR is Not the Original  
 PB (Owner's Signature)

2018 AUG 29 P 1:23  
 PHOENIX, ARIZONA  
 RECEIVED  
 STATE OFFICE

(Continued on page 2)

7 NW/PO

Copy

(Owner's Name - Please Print)	(Owner's Signature)
(Owner's Mailing Address)	(City) (State) (Zip Code)
(Owner's Name - Please Print)	(Owner's Signature)
(Owner's Mailing Address)	(City) (State) (Zip Code)
(Owner's Name - Please Print)	(Owner's Signature)
(Owner's Mailing Address)	(City) (State) (Zip Code)
(Owner's Name - Please Print)	(Owner's Signature)
(Owner's Mailing Address)	(City) (State) (Zip Code)

18 U.S.C. 1001 and 43 U.S.C. 1212 make it a crime for any person knowingly and willfully to make to any department or agency of the United States any false, fictitious or fraudulent statements or representations as to any matter within its jurisdiction.

**INSTRUCTIONS**

1. This certification is made under the provisions of 43 U.S.C. § 1744 and 30 U.S.C. §28-28k and the regulations thereunder (43 CFR Part 3830).
2. The claimant(s) must fill in the dates in paragraph 1 for the beginning and ending of the assessment year for which this waiver is sought.
3. The claimant(s) must fill in the date in paragraph 2 for the beginning of the assessment year for which this waiver is sought.
4. All claim and site names and BLM serial numbers must be listed for the mining claims, mill sites, and tunnel sites for which the waiver is sought.
5. All owners of the mining claims, mill sites, and tunnel sites and their addresses must be given.
6. This waiver form must be signed by all the claimants or their designated agent, in original form. If an agent is designated, a notarized designation of agent, signed by all of the claimants with proper address given, must be submitted with this waiver.
7. This form must be filed no later than September 1st for the upcoming assessment year in the BLM State Office where the mining claims or sites are recorded, or the waiver cannot be granted by the BLM. (Example: To obtain a waiver for the assessment year 2012, which begins on September 1, 2011, you must qualify for and file for a waiver no later than September 1, 2011, in the proper BLM State Office.)
8. For all mining claims which require assessment work, you must record an affidavit of labor on or before the December 30th immediately following the filing of this waiver. For all other mining claims or sites waived, you must record a notice of intent to hold on or before the December 30th immediately following the filing of this waiver.
9. Mill and tunnel sites may also be listed on this waiver and be waived from payment of the maintenance fee. A notice of intent to hold for these sites is required to be filed by the December 30th following the filing of this waiver.

**FOR OFFICIAL USE ONLY**

DEPARTMENT OF THE INTERIOR  
BUREAU OF LAND MANAGEMENT  
MINING CLAIMS

(LIVE) Serial Register Page

Run Date/Time: 9/12/2018 7:57 AM

Page 1 Of 2

**01 05-10-1872;017STAT0091;30USC26,28,34**

**Total Acres**

**Serial Number**

**Case Type: 384101: LODE CLAIM**

**20.660**

**AMC352160**

**Claim Name: MUSTANG**

**Commodity:**

**Case Disposition: ACTIVE**

**Lead File Number**

**Required Maintenance Fee: 155.00**

**AMC352160**

**Name & Address Interest Relationship**

WALDECK BILL C                      PO BOX 566                      RIMROCK AZ 86335-0566                      CLAIMANT

Mer	Twp	Rng	Sec	Quadrant	District	County / State
14	0080N	0010W	003	NE SE	HASSAYAMPA FIELD OFFICE	YAVAPAI AZ

Act Date	Code	Action Text	Action Remarks	Receipt Number
04/01/1999	403	LOCATION DATE		
05/27/1999	395	RECORDATION NOTICE RECD		
08/29/2018	483	SMALL MINER CERT FILED	2019	
08/18/2017	782	MAINTENANCE FEE PAYMENT	2018;\$155	3945589
08/29/2018	480	EVID OF ASSMT FILED	2018	4248979
08/23/2016	782	MAINTENANCE FEE PAYMENT	2017;\$155	3638718
08/21/2015	782	MAINTENANCE FEE PAYMENT	2016;\$155	3373641
08/20/2014	782	MAINTENANCE FEE PAYMENT	2015;\$155	3107174
08/14/2013	682	MAINTENANCE FEE/\$140	2014;\$140	2855392
08/30/2012	682	MAINTENANCE FEE/\$140	2013;\$140	2645698
08/31/2011	682	MAINTENANCE FEE/\$140	2012	2421702
08/25/2010	682	MAINTENANCE FEE/\$140	2011	2200481
08/27/2009	682	MAINTENANCE FEE/\$140	2010	1993599
08/29/2008	582	MAINTENANCE FEE/\$125	2009	1776695
08/30/2007	582	MAINTENANCE FEE/\$125	2008	1557567
08/24/2006	582	MAINTENANCE FEE/\$125	2007	1342368
08/22/2005	582	MAINTENANCE FEE/\$125	2006	1137460
08/31/2004	582	MAINTENANCE FEE/\$125	2005	946039
08/12/2003	482	MAINTENANCE FEE/\$100	2004	728316
08/20/2002	482	MAINTENANCE FEE/\$100	2003	544413
08/20/2001	482	MAINTENANCE FEE/\$100	2002	360799
08/25/2000	482	MAINTENANCE FEE/\$100	2001	176641
08/30/1999	482	MAINTENANCE FEE/\$100	2000	
05/27/1999	482	MAINTENANCE FEE/\$100	1999	
08/29/2018	247	FUTURE ACTION SUSPENSE	2019 WVR CORRECTION	
08/29/2018	396	TRF OF INTEREST FILED	CLARK PAUL	4248949
06/16/1999	669	LAND STATUS CHECKED		
05/27/1999	501	ACCT ADV IN LEAD FILE	AMC352160;	
04/20/1999	404	COUNTY RECORDATION	0;3656;528	

**Line Nr Remarks**



DEPARTMENT OF THE INTERIOR  
BUREAU OF LAND MANAGEMENT  
MINING CLAIMS

(LIVE) Serial Register Page

Run Date/Time: 9/12/2018 7:57 AM

Page 2 Of 2

0001  
0002

ORIGINAL 2019 WAIVER WAS RTN TO CLAIMANT BY MISTAKE;  
CLAIMANT NOTIFIED BY MAIL ON 9/12/2018 TO RTN WVR;

9/12/2018

BILL WALDECK  
PO BOX 566  
RIMROCK, AZ 86335-0566

Sir,

- It appears that our office mailed the Original 2019 Waiver back to you.
- The waiver was received in our office on Aug 29, 2018 (**date stamp in blue ink**).
- Please return the Original 2019 Waiver to our office.
- We **must** have the Original back in order for you to receive credit for the waiver.

If you have any questions, please call Pauline Brown at 602-417-9360.

Regards,

PAULINE BROWN  
LAND LAW EXAMINER  
BUREAU OF LAND MANAGEMENT  
ARIZONA STATE OFFICE  
ONE NORTH CENTRAL AVE, STE 800  
PHOENIX, AZ 85004-4427  
OFFICE: (602) 417-9360  
FAX: (602) 417-9490  
[paulinebrown@blm.gov](mailto:paulinebrown@blm.gov)  
[www.blm.gov/az](http://www.blm.gov/az)  
<https://www.facebook.com/BLMArizona>

352160

When Recorded Return Document to:  
Bill C. WALDECK  
P.O. Box 566  
Rim Rock, AZ  
86335

Check here is this is a change of address.  
Telephone: \_\_\_\_\_  
E-mail address: \_\_\_\_\_

**AFFIDAVIT OF PERFORMANCE OF ANNUAL WORK**

1. State of Arizona, County of YAVAPAI ss:  
2. I (Name) BILL C. WALDECK  
3. Reside at (Address) P.O. BOX 566  
City RIM ROCK County YAVAPAI

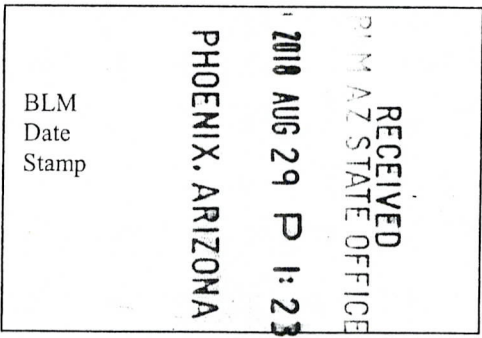

State AZ Zip 86335 being duly sworn, depose and say that I am a citizen of the United States, more than eighteen years of age, and that all of the facts set forth in this affidavit, subject to the provisions and penalties of 18 U.S.C. 1001 pertaining to the filing of false, fictitious, or fraudulent statements with the United States, are true and correct according to the best of my knowledge, information and belief.

4. Owner's name and address (If not shown in Items 1-3 above). \_\_\_\_\_

5. That I am personally acquainted with the mining claim(s). The work and improvements were made by and at the expense of the owner(s) of said claim(s). Said contiguous group of claims, listed on this document, are situated in the

SILVER MTN. (optional) Mining District; YAVAPAI County, Arizona.

Line No.	AMC NUMBER	CLAIM/SITE NAME	COUNTY RECORDER DATA (If available)	TWP	RNG	SEC
1	352160	MUSTANG		8N	1W	3
2						
3						
4						
5						
6						

Form: MCF108  
Revised July 2014  
Page 1 of 2

**ENTERED**  
**AUG 31 2018**  
BY: RAm



RECEIVED  
BLM AZ STATE OFFICE  
PHOENIX, ARIZONA  
2018 AUG 29 P 1:23

BLM  
Date  
Stamp

7					
8					
9					
10					

6. That between the dates starting at 12 o'clock noon on September 1, 20 17 and ending at 12 o'clock noon on September 1, 20 18 at least \$ 600. dollars worth of work and improvements were done and performed upon said claim(s) or upon one or more of a contiguous group of claims for the benefit of all, wholly or partly outside of a contiguous group of claims for the benefit of all, not including the location work.

7. That the following persons were employed to perform the work and improvements described herein: Bill WALDECK

8. That the work and improvements performed were: ROAD IMPROVEMENTS AND BULK SAMPLING

9. Dated: 8-28-18 Signature: Bill C. Waldeck

SUBSCRIBED AND SWORN TO before me, a Notary Public, this 28th day of August 20 18  
In the State of Arizona, County of Yavapai

By: Anita R. McCarthy

Notary Public Anita R. McCarthy

My Commission Expires 2-27-2022

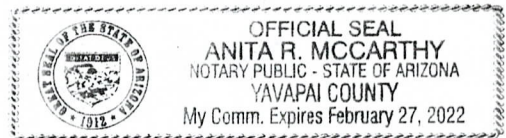

Bureau of Land Management  
Arizona State Office  
[www.blm.gov/az](http://www.blm.gov/az)

No. of Claims: 1 x \$10 = 10<sup>00</sup>  
 Check No.: \_\_\_\_\_ Init. DET  
 Receipt No.: 4248979  
 For BLM Use Only

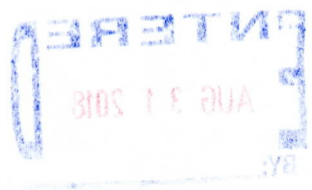

**United States Department of the Interior**  
**Bureau of Land Management**  
 DIV OF LANDS, MINRLS & ENERGY  
 ONE N CENTRAL AVE  
 PHOENIX, AZ 85004 -4427  
 Phone: 602-417-9200

Receipt

No: 4248979

<b>Transaction #:</b> 4364464	
<b>Date of Transaction:</b> 08/29/2018	
<b>CUSTOMER:</b>	
BILL C WALDECK PO BOX 566 RIMROCK, AZ 86335-0566 US	

LINE #	QTY	DESCRIPTION	REMARKS	UNIT PRICE	TOTAL
1	1.00	LOCATABLE MINERALS / MINING CLAIMS-NOT NEW-UNADJUD, ONE AUTH NO. ONLY / MINING CLAIM MONEY RECEIVED CASES: AMC352160/\$10.00	2018 POL AND WAIVER/1	- n/a -	10.00
<b>TOTAL:</b>					<b>\$10.00</b>

PAYMENT INFORMATION				
NOTE: Items will appear on credit card statement as "Bureau of Land Mgmt CO".				
1	AMOUNT:	10.00	POSTMARKED:	N/A
	TYPE:	CREDIT CARD	RECEIVED:	08/29/2018
	NAME:	WALDECK, BILL C PO BOX 566 RIMROCK AZ 86335-0566 US		
	CARD NO:	XXXXXXXXXXXX0722	AUTH CODE:	133844
	NAME ON CARD:	BILL C MALDECK		
	SIGNATURE:			

REMARKS

This receipt was generated by the automated BLM Collections and Billing System and is a paper representation of a portion of the official electronic record contained therein.

Run Date: 08/21/17

Run Time: 09:47 AM

**DEPARTMENT OF THE INTERIOR  
BUREAU OF LAND MANAGEMENT  
MINING CLAIMS**

**MC Maintenance Fees Paid Through the BLM Pay Portal**

**CBS Receipt: 3945589**

Printed For Lead File # AMC352160

Agency Tracking ID: 1503095096

Number of BLM Serial Nr: 1

Assessment Year: 2018

Total Amount Paid: \$155.00

Paid On: 08/18/2017

Claim Name	BLM Serial No	Lead File No	Amount Paid
MUSTANG	AMC352160	AMC352160	\$155.00

**United States Department of the Interior**  
**Bureau of Land Management**  
 BUSINESS & SUPPORT SVCS DIV  
 ONE N CENTRAL AVE SUITE 800  
 PHOENIX, AZ 85004 -4427  
 Phone: 602-417-9200

Receipt

No: 3945589

<b>Transaction #:</b> 4055283	
<b>Date of Transaction:</b> 08/18/2017	
<b>CUSTOMER:</b>	
PAUL CLARK PO BOX 1308 CONGRESS, AZ 85332 US	

LINE #	QTY	DESCRIPTION	REMARKS	UNIT PRICE	TOTAL
1	1.00	LOCATABLE MINERALS / MINING CLAIMS- NOT NEW-UNADJUD, ONE AUTH NO. ONLY / MINING CLAIM MONEY RECEIVED <b>CASES: AMC352160/\$155.00</b>		- n/a -	155.00
<b>TOTAL:</b>					<b>\$155.00</b>

PAYMENT INFORMATION			
NOTE: Items will appear on credit card statement as "BLM O Mining Claim".			
1	AMOUNT:	155.00	POSTMARKED: N/A
	TYPE:	CREDIT CARD	RECEIVED: 08/18/2017
	NAME:	PAUL CLARK PO BOX 1308 CONGRESS AZ 85332 US	
	CARD NO:	XXXXXXXXXXXX8034	AUTH CODE: 094578
	NAME ON CARD:	PAUL CLARK	
	EXPIRES:	07/2021	
	SIGNATURE:		

REMARKS

This receipt was generated by the automated BLM Collections and Billing System and is a paper representation of a portion of the official electronic record contained therein.



UNITED STATES  
DEPARTMENT OF THE INTERIOR  
BUREAU OF LAND MANAGEMENT

AMC 352160  
375662

**CREDIT CARD PAYMENT**  
**For Mining Claim Maintenance Fee**

THIS IS A CHANGE OF ADDRESS

TELEPHONE SUBMISSION - ACCURACY OF THE BELOW INFORMATION IS THE RESPONSIBILITY OF THE CLAIMANT/OWNER

NAME PAUL CLARK  
ADDRESS P O BOX 1308 ✓  
CITY CONGRESS STATE AZ ZIP 85332  
PHONE # 928 - 231-3145

SEND RECEIPT TO  Above address  
 Other (Include Name and Mailing Address):

\_\_\_\_\_  
\_\_\_\_\_  
\_\_\_\_\_

AMC NUMBER	CLAIM/SITE NAME
20 <u>352160</u>	<u>MUSTANG</u>
40 ACRES <u>375662</u>	<u>YAMAHA 1</u>
40 ACRES <u>375663</u>	<u>YAMAHA 2</u>

AC 782  
ENTERED AUG 24 2016  
PB

3 # of Claim/Site  
5 x 155.00 Each 20 ac. segment  
\$ 775 Total Charged EC (INITIALS)

RECEIPT # 3638718

DATE STAMP  
RECEIVED  
BLM PHOENIX OFFICE  
PHOENIX, ARIZONA  
2016 AUG 23 P 3:32

\*\*\*\*\* FOR OFFICIAL USE ONLY \*\*\*\*\*  
DATE \_\_\_\_\_ INITIALS \_\_\_\_\_ VERIFIED \_\_\_\_\_

### Customer Name Update Screen

System ID:MC

Name: CLARK PAUL

Proprietor #: 2240537

Renumber To:

Category: P - PRIVATE

Address: PO BOX 1308

City: CONGRESS

State: AZ

Zip: 853321308

UNDELIVERABLE

Email:

Phone: 928-231-3145

*ph # Entered*  
**ENTERED AUG 24 2016**  
*FB*

Customer details successfully saved for Customer Id 2240537

**List of Proprietors**

CLARK PAUL[2240537], PO BOX 1308, , CONGRESS, AZ, 853321308, P, MATCHED  
CLARK PAUL C[14477], BOX 562, , NEEDLES, CA, 92363, P,

TWO DIFFERENT PEOPLE. MS

8/24/16 5:00pm I called Paul Clark @ 928-231-3145,  
He stated he never owned a Address in CA. OK, I  
called to verify that.

Do NOT CONSOLIDATE THESE ADDRESSES. MS

Select

Cancel

**United States Department of the Interior**  
**Bureau of Land Management**  
 DIV OF LANDS, MINRLS & ENERGY  
 ONE N CENTRAL AVE  
 PHOENIX, AZ 85004 -4427  
 Phone: 602-417-9200

Receipt

No: 3638718

<b>Transaction #:</b> 3742629		<i>AC 782</i>
<b>Date of Transaction:</b> 08/23/2016		<b>ENTERED AUG 24 2016</b>
<b>CUSTOMER:</b> <i>PB</i>		
PAUL CLARK PO BOX 1308 CONGRESS, AZ 85332-1308 US		

LINE #	QTY	DESCRIPTION	REMARKS	UNIT PRICE	TOTAL
1	1.00	LOCATABLE MINERALS / MINING CLAIMS- NOT NEW-UNADJUD, ONE AUTH NO. ONLY / MINING CLAIM MONEY RECEIVED <b>CASES: AMC352160/\$775.00</b>	2017 MAINT (3)	- n/a -	775.00
<b>TOTAL:</b>					<b>\$775.00</b>

PAYMENT INFORMATION			
NOTE: Items will appear on credit card statement as "Bureau of Land Mgmt CO".			
1	AMOUNT:	775.00	POSTMARKED: N/A
	TYPE:	CREDIT CARD	RECEIVED: 08/23/2016
	NAME:	CLARK, PAUL PO BOX 1308 CONGRESS AZ 85332-1308 US	
	CARD NO:	XXXXXXXXXXXX8034	AUTH CODE: 351062
	NAME ON CARD:	PAUL CLARK	
	EXPIRES:	10/2017	
	SIGNATURE:		

REMARKS

This receipt was generated by the automated BLM Collections and Billing System and is a paper representation of a portion of the official electronic record contained therein.



UNITED STATES  
DEPARTMENT OF THE INTERIOR  
BUREAU OF LAND MANAGEMENT

352160  
375662

**CREDIT CARD PAYMENT**  
**For Mining Claim Maintenance Fee**

THIS IS A CHANGE OF ADDRESS

TELEPHONE SUBMISSION - ACCURACY OF THE BELOW INFORMATION IS THE RESPONSIBILITY OF THE CLAIMANT/OWNER

NAME PAUL CLARK  
ADDRESS PO BOX 1308  
CITY CONROES STATE \_\_\_\_\_ ZIP 85332  
PHONE # 928 - 231 3145

SEND RECEIPT TO  Above address  
 Other (Include Name and Mailing Address):  
\_\_\_\_\_  
\_\_\_\_\_  
\_\_\_\_\_

AMC NUMBER	CLAIM/SITE NAME
<u>AMC 352160</u>	<u>MUSTANG 6 / 20</u>
<u>375662</u>	<u>YAMAHA 1 / 40</u>
<u>375663</u>	<u>YAMAHA 2 / 40</u>

\_\_\_\_\_ # of Claim/Site  
x 155.00 Each  
\$ 775.00 Total Charged PER (INITIALS)

RECEIPT # 3373641

DATE STAMP

RECEIVED  
BLM AZ STATE OFFICE  
2015 AUG 21 P 3:29  
PHOENIX, ARIZONA  
ENTERED  
AUG 26 2015  
BY IK

\*\*\*\*\* FOR OFFICIAL USE ONLY \*\*\*\*\*

DATE 8/21/15 INITIALS PER VERIFIED \_\_\_\_\_

**United States Department of the Interior**  
**Bureau of Land Management**  
 LANDS/RECREATION & PLANNING  
 ONE N CENTRAL AVE  
 PHOENIX, AZ 85004 -2203  
 Phone: 602-417-9200

Receipt

No: 3373641

<b>Transaction #:</b> 3471839	
<b>Date of Transaction:</b> 08/21/2015	
CUSTOMER:	
PAUL CLARK PO BOX 1308 CONGRESS, AZ 85332-1308 US	

LINE #	QTY	DESCRIPTION	REMARKS	UNIT PRICE	TOTAL
1	1.00	LOCATABLE MINERALS / MINING CLAIMS-NOT NEW-UNADJUD, ONE AUTH NO. ONLY / MINING CLAIM MONEY RECEIVED CASES: AMC352160/\$775.00	2016 MAINT/3	- n/a -	775.00
<b>TOTAL:</b>					<b>\$775.00</b>

PAYMENT INFORMATION					
NOTE: Items will appear on credit card statement as "Bureau of Land Mgmt CO".					
1	AMOUNT:	775.00	POSTMARKED:	N/A	
	TYPE:	CREDIT CARD	RECEIVED:	08/21/2015	
	NAME:	CLARK, PAUL PO BOX 1308 CONGRESS AZ 85332-1308 US			
	CARD NO:	XXXXXXXXXXXX8034	AUTH CODE:	969808	
	NAME ON CARD:	PAUL CLARK			
	EXPIRES:	10/2017			
	SIGNATURE:				

REMARKS

This receipt was generated by the automated BLM Collections and Billing System and is a paper representation of a portion of the official electronic record contained therein.

**ENTERED**  
**AUG 26 2015**  
 BY: *VR*

352160  
375662

UNITED STATES  
DEPARTMENT OF THE INTERIOR  
BUREAU OF LAND MANAGEMENT

**CREDIT CARD PAYMENT**  
**For Mining Claim Maintenance Fee**

THIS IS A CHANGE OF ADDRESS

TELEPHONE SUBMISSION - ACCURACY OF THE BELOW INFORMATION IS THE RESPONSIBILITY OF THE CLAIMANT/OWNER

NAME Paul Clark  
ADDRESS Po BOX 1308  
CITY Congress STATE \_\_\_\_\_ ZIP 85332  
PHONE # 928 - 231-3145

SEND RECEIPT TO  Above address  
 Other (Include Name and Mailing Address):  
\_\_\_\_\_  
\_\_\_\_\_  
\_\_\_\_\_

20 ac 352160  
40 ac 375662  
40 ac 375663

CLAIM/SITE NAME  
Mustang  
Yamaha 1  
Yamaha 2

3 # of Claim/Site  
x 155.00 Each  
\$ 775. Total Charged SC (INITIALS)

RECEIPT # 3107174

DATE STAMP

RECEIVED  
BLM AZ STATE OFFICE  
2014 AUG 20 P 3:54  
PHOENIX, ARIZONA

INTERESTED  
AUG 22 2014  
BY: RAM

\*\*\*\*\* FOR OFFICIAL USE ONLY \*\*\*\*\*  
DATE \_\_\_\_\_ INITIALS \_\_\_\_\_ VERIFIED \_\_\_\_\_



**United States Department of the Interior**  
**Bureau of Land Management**  
 LANDS/RECREATION & PLANNING  
 ONE N CENTRAL AVE  
 PHOENIX, AZ 85004 -2203  
 Phone: 602-417-9200

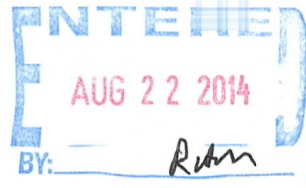

Receipt

No: 3107174

<b>Transaction #:</b> 3198819	
<b>Date of Transaction:</b> 08/20/2014	
<b>CUSTOMER:</b>	
	PAUL CLARK PO BOX 1308 CONGRESS, AZ 85332-1308 US

LINE #	QTY	DESCRIPTION	REMARKS	UNIT PRICE	TOTAL
1	1.00	LOCATABLE MINERALS / MINING CLAIMS- NOT NEW-UNADJUD, ONE AUTH NO. ONLY / MINING CLAIM MONEY RECEIVED <b>CASES: AMC352160/\$775.00</b>	MAINT (3) 2015	- n/a -	775.00
<b>TOTAL:</b>					<b>\$775.00</b>

PAYMENT INFORMATION			
NOTE: Items will appear on credit card statement as "Bureau of Land Mgmt CO".			
1	AMOUNT:	775.00	POSTMARKED: N/A
	TYPE:	CREDIT CARD	RECEIVED: 08/20/2014
	NAME:	CLARK, PAUL PO BOX 1308 CONGRESS AZ 85332-1308 US	
	CARD NO:	XXXXXXXXXXXX1115	AUTH CODE: 045305
	NAME ON CARD:	PAUL CLARK	
	EXPIRES:	02/2016	
	SIGNATURE:		

REMARKS

This receipt was generated by the automated BLM Collections and Billing System and is a paper representation of a portion of the official electronic record contained therein.



UNITED STATES  
DEPARTMENT OF THE INTERIOR  
BUREAU OF LAND MANAGEMENT

AMC 352160  
AMC 375662

**CREDIT CARD PAYMENT**  
**For Mining Claim Maintenance Fee**

THIS IS A CHANGE OF ADDRESS

TELEPHONE SUBMISSION - ACCURACY OF THE BELOW INFORMATION IS THE RESPONSIBILITY OF THE CLAIMANT/OWNER

NAME Paul Clark  
ADDRESS Box 1308  
CITY Congress STATE AZ ZIP 85332  
PHONE # 928-231-3145

SEND RECEIPT TO  Above address  
 Other (Include Name and Mailing Address):  
\_\_\_\_\_  
\_\_\_\_\_  
\_\_\_\_\_

AMC NUMBER	CLAIM/SITE NAME
<u>352160 20</u>	_____
<u>375662 40</u>	_____
<u>375663 40</u>	_____

3 # of Claim/Site  
x 140 ~~125.00~~ Each  
\$ 700 Total Charged AMC (INITIALS)

# 2855392

DATE STAMP  
RECEIVED  
BLM AZ STATE OFFICE  
PHOENIX, ARIZONA  
AUG 14 P 2:25

ENTERED  
AUG 22 2013  
BY: TA

\*\*\*\* FOR OFFICIAL USE ONLY \*\*\*\*  
DATE \_\_\_\_\_ INITIALS \_\_\_\_\_ VERIFIED \_\_\_\_\_

United States Department of the Interior  
 Bureau of Land Management  
 LANDS/RECREATION & PLANNING  
 ONE N CENTRAL AVE  
 PHOENIX, AZ 85004 -2203  
 Phone: 602-417-9200

Receipt

No: 2855392

<b>Transaction #:</b> 2941186	
<b>Date of Transaction:</b> 08/14/2013	
<b>CUSTOMER:</b>	
PAUL CLARK PO BOX 1308 CONGRESS, AZ 85332-1308 US	

LINE #	QTY	DESCRIPTION	REMARKS	UNIT PRICE	TOTAL
1	1.00	LOCATABLE MINERALS / MINING CLAIMS-NOT NEW-UNADJUD, ONE AUTH NO. ONLY / MINING CLAIM MONEY RECEIVED CASES: AMC352160/\$700.00	MAINT 2014/3	- n/a -	700.00
<b>TOTAL:</b>					<b>\$700.00</b>

PAYMENT INFORMATION			
NOTE: Items will appear on credit card statement as "Bureau of Land Mgmt CO".			
1	AMOUNT:	700.00	POSTMARKED: N/A
	TYPE:	CREDIT CARD	RECEIVED: 08/14/2013
	NAME:	CLARK, PAUL PO BOX 1308 CONGRESS AZ 85332-1308 US	
	CARD NO:	XXXXXXXXXXXX1674	AUTH CODE: 115306
	NAME ON CARD:	PAUL CLARK	
	EXPIRES:	05/2016	
	SIGNATURE:		

REMARKS

This receipt was generated by the automated BLM Collections and Billing System and is a paper representation of a portion of the official electronic record contained therein.

AMC 352160

UNITED STATES  
DEPARTMENT OF THE INTERIOR  
BUREAU OF LAND MANAGEMENT

**CREDIT CARD PAYMENT**  
**For Mining Claim Maintenance Fee**

THIS IS A CHANGE OF ADDRESS

TELEPHONE SUBMISSION - ACCURACY OF THE BELOW INFORMATION IS THE RESPONSIBILITY OF THE CLAIMANT/OWNER

NAME PAUL CLARK  
ADDRESS PO BOX 1308  
CITY CONGRESS STATE AZ ZIP 85332  
PHONE # 928 - 427 9503

SEND RECEIPT TO  Above address  
 Other (include Name and Mailing Address):

\_\_\_\_\_  
\_\_\_\_\_  
\_\_\_\_\_

AMC NUMBER  
352160

CLAIM/SITE NAME  
MUSTANG  
SEP 09 2011  
M

1 # of Claim/Site  
x 140.00 Each  
\$ 140 Total Charged MC (INITIALS)

RECEIPT # 2421702

DATE STAMP  
RECEIVED  
BLM AZ STATE OFFICE  
2011 AUG 31 A 9:45  
PHOENIX, ARIZONA

\*\*\*\*\* FOR OFFICIAL USE ONLY \*\*\*\*\*  
DATE \_\_\_\_\_ INITIALS \_\_\_\_\_ VERIFIED \_\_\_\_\_



**United States Department of the Interior**  
**Bureau of Land Management**  
 LANDS/RECREATION & PLANNING  
 ONE N CENTRAL AVE  
 PHOENIX, AZ 85004 -2203  
 Phone: 602-417-9200

Receipt

No: 2421702

<b>Transaction #:</b> 2497140	
<b>Date of Transaction:</b> 08/31/2011	
CUSTOMER:	
PAUL CLARK PO BOX 1308 CONGRESS, AZ 85332-1308 US	 <b>SEP 09 2011</b>

LINE #	QTY	DESCRIPTION	REMARKS	UNIT PRICE	TOTAL
1	1.00	LOCATABLE MINERALS / MINING CLAIMS-NOT NEW-UNADJUD, ONE AUTH NO. ONLY / MINING CLAIM MONEY RECEIVED CASES: AMC352160/\$140.00	MAINT 2012/1	- n/a -	140.00
<b>TOTAL:</b>					<b>\$140.00</b>

PAYMENT INFORMATION			
NOTE: Items will appear on credit card statement as "Bureau of Land Mgmt CO".			
1	AMOUNT:	140.00	POSTMARKED: N/A
	TYPE:	CREDIT CARD	RECEIVED: 08/31/2011
	NAME:	CLARK, PAUL PO BOX 1308 CONGRESS AZ 85332-1308 US	
	CARD NO:	XXXXXXXXXXXX9629	AUTH CODE: 130625
	NAME ON CARD:	PAUL CLARK	
	EXPIRES:	02/2014	
	SIGNATURE:		

REMARKS

This receipt was generated by the automated BLM Collections and Billing System and is a paper representation of a portion of the official electronic record contained therein.



AMC 352160

UNITED STATES  
DEPARTMENT OF THE INTERIOR  
BUREAU OF LAND MANAGEMENT

**CREDIT CARD PAYMENT**  
**For Mining Claim Maintenance Fee**

THIS IS A CHANGE OF ADDRESS

TELEPHONE SUBMISSION - ACCURACY OF THE BELOW INFORMATION IS THE RESPONSIBILITY OF THE CLAIMANT/OWNER

NAME Paul Clark  
ADDRESS P.O. Box 1308  
CITY Congress STATE AZ ZIP 85332  
PHONE # 928 - 427-9503

SEND RECEIPT TO  Above address  
 Other (Include Name and Mailing Address):

ENTERED INTO COMPUTER  
SEP 14 2010

AMC NUMBER  
352160

CLAIM/SITE NAME  
Mustang

1 # of Claim/Site  
x 140.00 Each  
\$ 140.00 Total Charged AK (INITIALS)

RECEIPT # 2200481

DATE STAMP

RECEIVED  
BLM AZ STATE OFFICE  
2010 AUG 25 P 11:15  
PHOENIX, ARIZONA

\*\*\*\*\* FOR OFFICIAL USE ONLY \*\*\*\*\*

DATE \_\_\_\_\_ INITIALS \_\_\_\_\_ VERIFIED \_\_\_\_\_

**United States Department of the Interior**  
**Bureau of Land Management**  
 LANDS/RECREATION & PLANNING  
 ONE N CENTRAL AVE  
 PHOENIX, AZ 85004 -2203  
 Phone:

Receipt

No: 2200481

<b>Transaction #:</b> 2270407		<b>ENTERED INTO COMPUTER</b>
<b>Date of Transaction:</b> 08/25/2010		
<b>CUSTOMER:</b>	PAUL CLARK PO BOX 1308 CONGRESS, AZ 85332-1308 US	SEP 14 2010

LINE #	QTY	DESCRIPTION	REMARKS	UNIT PRICE	TOTAL
1	1.00	LOCATABLE MINERALS / MINING CLAIMS- NOT NEW-UNADJUD, ONE AUTH NO. ONLY / MINING CLAIM MONEY RECEIVED CASES: AMC352160/\$140.00	MAINT FEE PYMNT (1) 2011	- n/a -	140.00
<b>TOTAL:</b>					<b>\$140.00</b>

PAYMENT INFORMATION			
NOTE: Items will appear on credit card statement as "Bureau of Land Mgmt CO".			
1	<b>AMOUNT:</b>	140.00	<b>POSTMARKED:</b> N/A
	<b>TYPE:</b>	CREDIT CARD	<b>RECEIVED:</b> 08/25/2010
	<b>NAME:</b>	CLARK, PAUL PO BOX 1308 CONGRESS AZ 85332-1308 US	
	<b>CARD NO:</b>	XXXXXXXXXXXX9629	<b>AUTH CODE:</b> 185828
	<b>NAME ON CARD:</b>	PAUL CLARK	
	<b>EXPIRES:</b>	02/2014	
	<b>SIGNATURE:</b>		

REMARKS

This receipt was generated by the automated BLM Collections and Billing System and is a paper representation of a portion of the official electronic record contained therein.

UNITED STATES  
DEPARTMENT OF THE INTERIOR  
BUREAU OF LAND MANAGEMENT

AMC 352160

**CREDIT CARD PAYMENT**  
**For Mining Claim Maintenance Fee**

THIS IS A CHANGE OF ADDRESS

TELEPHONE SUBMISSION - ACCURACY OF THE BELOW INFORMATION IS THE RESPONSIBILITY OF THE CLAIMANT/OWNER

NAME Paul Clark  
ADDRESS P.O. Box 1308  
CITY Congress STATE AZ ZIP 85332  
PHONE # 928 - 427-9503

SEND RECEIPT TO  Above address  
 Other (Include Name and Mailing Address):

\_\_\_\_\_  
\_\_\_\_\_  
\_\_\_\_\_  
\_\_\_\_\_

AMC NUMBER

352160

CLAIM/SITE NAME

Mustang

1 # of Claim/Site

x 140.00 Each

\$ 140.00 Total Charged AH (INITIALS)

RECEIPT # 1993599

DATE STAMP

PHOENIX, ARIZONA

2009 AUG 27 A 11:08

RECEIVED  
BLMAZ STATE OFFICE



\*\*\*\*\* FOR OFFICIAL USE ONLY \*\*\*\*\*

DATE \_\_\_\_\_

INITIALS \_\_\_\_\_

VERIFIED \_\_\_\_\_

**United States Department of the Interior**

**Bureau of Land Management**  
 BUSINESS & SUPPORT SVCS DIV  
 ONE N CENTRAL AVE SUITE 800  
 PHOENIX, AZ 85004 -4427  
 Phone: (602) 417-9200

Receipt

No: 1993599

<b>Transaction #:</b> 2057864	
<b>Date of Transaction:</b> 09/01/2009	
<b>CUSTOMER:</b>	PAUL CLARK PO BOX 1308 CONGRESS,AZ 85332-1308 US

LINE #	QTY	DESCRIPTION	REMARKS	UNIT PRICE	TOTAL
1	1.00	LOCATABLE MINERALS / MINING CLAIMS-NOT NEW-UNADJUD,ONE AUTH NO. ONLY / MINING CLAIM MONEY RECEIVED CASES: AMC352160/\$140.00	MAINT (1)	- n/a -	140.00
<b>TOTAL:</b>					<b>\$140.00</b>

PAYMENT INFORMATION			
NOTE: Items will appear on credit card statement as "Bureau of Land Mgmt CO".			
1	AMOUNT:	140.00	POSTMARKED: N/A
	TYPE:	CREDIT CARD	RECEIVED: 09/01/2009
	NAME:	CLARK, PAUL PO BOX 1308 CONGRESS AZ 85332-1308 US	
	CARD NO:	XXXXXXXXXXXX3412	AUTH CODE: 186627
	NAME ON CARD:	PAUL CLARK	
	EXPIRES:	02/2011	
	SIGNATURE:		

REMARKS

This receipt was generated by the automated BLM Collections and Billing System and is a paper representation of a portion of the official electronic record contained therein.



AMC 352160

UNITED STATES  
DEPARTMENT OF THE INTERIOR  
BUREAU OF LAND MANAGEMENT

CREDIT CARD PAYMENT  
FOR MINING CLAIM MAINTENANCE FEE

NAME Paul Clark

ADDRESS PO Box 1308

CITY Congress STATE Az ZIP 85332

PHONE # (928) 427-9503

[ ] THIS IS A CHANGE OF ADDRESS

AMC NUMBER

CLAIM/SITE NAME

352160

MUSTANG

DATE STAMP

COUNT 1 \$ 125 INITIALS SC

TELEPHONE SUBMISSION - ACCURACY OF THE ABOVE INFORMATION  
IS THE RESPONSIBILITY OF THE CLAIMANT/OWNER

FOR OFFICIAL USE ONLY

DATE \_\_\_\_\_ INITIALS \_\_\_\_\_ VERIFIED \_\_\_\_\_

ENTERED INTO COMPUTER

SEP 15 '08

TSB

**United States Department of the Interior**

**Bureau of Land Management**  
 BUSINESS & SUPPORT SVCS DIV  
 ONE N CENTRAL AVE SUITE 800  
 PHOENIX, AZ 85004 -4427  
 Phone: (602) 417-9200

Receipt

No: 1776695

<b>Transaction #:</b> 1834525	
<b>Date of Transaction:</b> 09/02/2008	
<b>CUSTOMER:</b>	PAUL CLARK PO BOX 1308 CONGRESS, AZ 85332

LINE #	QTY	DESCRIPTION	REMARKS	UNIT PRICE	TOTAL
1	1.00	LOCATABLE MINERALS / MINING CLAIMS-NOT NEW-UNADJUD, ONE AUTH NO. ONLY / MINING CLAIM MONEY RECEIVED (455) CASES: AMC352160/\$125.00	MAINT 2009 (1)	- n/a -	125.00
<b>TOTAL:</b>					<b>\$125.00</b>

PAYMENT INFORMATION			
NOTE: Items will appear on credit card statement as "Bureau of Land Mgmt CO".			
1	AMOUNT:	\$125.00	POSTMARKED: N/A
	TYPE:	CREDIT CARD	RECEIVED: 09/02/2008
	NAME:	CLARK, PAUL PO BOX 1308 CONGRESS AZ 85332	
	CARD NO:	XXXXXXXXXXXX1884	AUTH CODE: 00283A
	NAME ON CARD:	PAUL CLARK	
	EXPIRES:	06/30/2010	
	SIGNATURE:		

REMARKS

This receipt was generated by the automated BLM Collections and Billing System and is a paper representation of a portion of the official electronic record contained therein.

# MAINTENANCE FEE PAYMENT

AMC 352160  
AMC 375662

**\$125.00 MAINTENANCE FEE PAYMENT DUE ON OR BEFORE AUGUST 31, 2007  
IN LIEU OF ASSESSMENT WORK FOR THE UPCOMING ASSESSMENT YEAR  
BEGINNING SEPTEMBER 1 OF THE YEAR NOTED ABOVE.**

BUREAU OF LAND MANAGEMENT  
ARIZONA STATE OFFICE  
1 NORTH CENTRAL AVENUE  
PHOENIX, AZ 85004

COUNT : \$ \_\_\_\_\_ INT. \_\_\_\_\_  
**FOR OFFICIAL USE ONLY**

THE CLAIM (S) ARE SITUATED IN YAVAPAI COUNTY, AZ

BLM SERIAL NUMBERS \_\_\_\_\_ NAME OF CLAIM(S) OR SITE \_\_\_\_\_

AMC 352160 THRU AMC \_\_\_\_\_ MUSTANG

BLM SERIAL NUMBER(S) \_\_\_\_\_ NAME OF CLAIM \_\_\_\_\_ COUNTY/BOOK/DOCKET & PAGE OR FEE NUMBER \_\_\_\_\_

AMC 352160 \_\_\_\_\_ MUSTANG \_\_\_\_\_ 3656 PG 528

AMC \_\_\_\_\_

AMC \_\_\_\_\_

CLAIMMANT NAME: PAUL CLARK

ADDRESS: PO. BOX 1308 CITY: CONGRESS STATE: AZ

PHONE: 928-427-9503 ZIP: 85332

\_\_\_\_\_. CHECK HERE IF THIS IS A CHANGE OF ADDRESS;

SIGNATURE: Paul Clark

TO RECORD WITH THE COUNTY, ONE CLAIMANT OR AGENT MUST SIGN.

LIST OF ADDITIONAL OWNERS ON SECOND PAGE IF NEED OF THIS FORM

**FOR OFFICAL USE ONLY**

ENTERED INTO COMPUTER; 9/21/07 \_\_\_\_\_  
DATE INITIAL VERIFIED

TIME STAMP

RECEIVED  
B.L.M. AZ STATE OFFICE  
2001 AUG 30 A 8:33  
PHOENIX, ARIZONA

# MAINTENANCE FEE PAYMENT

**\$125.00 MAINTENANCE FEE PAYMENT DUE ON OR BEFORE AUGUST 31, 2007  
IN LIEU OF ASSESSMENT WORK FOR THE UPCOMING ASSESSMENT YEAR  
BEGINNING SEPTEMBER 1 OF THE YEAR NOTED ABOVE.**

BUREAU OF LAND MANAGEMENT

ARIZONA STATE OFFICE  
1 NORTH CENTRAL AVENUE  
PHOENIX, AZ 85004

COUNT : \$ \_\_\_\_\_ INT. \_\_\_\_\_  
**FOR OFFICIAL USE ONLY**

THE CLAIM (S) ARE SITUATED IN YAVAPAI COUNTY, AZ

BLM SERIAL NUMBERS	NAME OF CLAIM(S) OR SITE	COUNTY/BOOK/DOCKET & PAGE OR FEE NUMBER
AMC 375662 THRU AMC 375663	YAMAHA#1 & 2	
AMC 375662	YAMAHA #1	BOOK 4463 PG 122
AMC 375663	YAMAHA #2	BOOK 4463 PG 121
AMC _____		

CLAIMANT NAME: PAUL CLARK

ADDRESS: PO. BOX 1308 CITY: CONGRESS STATE: AZ

PHONE: 928-427-9503 ZIP: 85332

CHECK HERE IF THIS IS A CHANGE OF ADDRESS;

SIGNATURE: Paul Clark

TO RECORD WITH THE COUNTY, ONE CLAIMANT OR AGENT MUST SIGN.

LIST OF ADDITIONAL OWNERS ON SECOND PAGE IF NEED OF THIS FORM

**FOR OFFICAL USE ONLY**

ENTERED INTO COMPUTER; 9/21/07 RE  
DATE INITIAL VERIFIED

TIME STAMP

RECEIVED  
BLM, ARIZONA STATE OFFICE  
2007 AUG 30 A 8:33  
PHOENIX, ARIZONA



CLAIM OWNER AND ADDRESSES

Paul Clark  
P.O. BOX 1308  
Congress AZ, 85332

Rick Johnson  
44265 Villeta Dr,  
LA Quinta, CA, 92253

Mike Wicks  
4705 Hunts Ct.  
Plant City, FL. 33567

Alvin Clark  
59 Ute Rd, apt 2  
Clovis NM 88101

RECEIVED  
B.L.M. AZ STATE OFFICE  
2001 AUG 30 A 8:33  
PHOENIX, ARIZONA

**United States Department of the Interior**

**Bureau of Land Management**

BUSINESS & SUPPORT SVCS DIV

ONE N CENTRAL AVE SUITE 800

PHOENIX, AZ 85004 -4427

Phone: (602) 417-9200

Receipt

No:

1557567

<b>Transaction #:</b> 1609203	
<b>Date of Transaction:</b> 08/30/2007	
<b>CUSTOMER:</b>	PAUL CLARK P.O. BOX 1308 CONGRESS, AZ 85332

LINE #	QTY	DESCRIPTION	REMARKS	UNIT PRICE	TOTAL
1	1.00	LOCATABLE MINERALS / MINING CLAIMS-NOT NEW-UNADJUD, ONE AUTH NO. ONLY / MINING CLAIM MONEY RECEIVED (455) <b>CASES: AMC375662/\$375.00</b>	MAINT 2008 (3)	- n/a -	375.00
<b>TOTAL:</b>					<b>\$375.00</b>

**PAYMENT INFORMATION**

1	<b>AMOUNT:</b>	\$250.00	<b>POSTMARKED:</b>	8/28/07 0:00
	<b>TYPE:</b>	CHECK	<b>RECEIVED:</b>	08/30/2007
	<b>CHECK NO:</b>	145		
	<b>NAME:</b>	CLARK, PAUL P.O. BOX 1308 CONGRESS AZ 85332		
2	<b>AMOUNT:</b>	\$125.00	<b>POSTMARKED:</b>	8/28/07 0:00
	<b>TYPE:</b>	CHECK	<b>RECEIVED:</b>	08/30/2007
	<b>CHECK NO:</b>	144		
	<b>NAME:</b>	CLARK, PAUL P.O. BOX 1308 CONGRESS AZ 85332		

**REMARKS**

This receipt was generated by the automated BLM Collections and Billing System and is a paper representation of a portion of the official electronic record contained therein.

AMC 352160

# MAINTENANCE FEE PAYMENT

\$125.00 MAINTENANCE FEE PAYMENT DUE ON OR BEFORE AUGUST 31, 2000 6.  
IN LIEU OF ASSESSMENT WORK FOR THE UPCOMING ASSESSMENT  
YEAR BEGINNING SEPTEMBER 1 OF THE YEAR NOTED ABOVE.

BUREAU OF LAND MANAGEMENT  
ARIZONA STATE OFFICE  
222 NORTH CENTRAL AVENUE  
PHOENIX, AZ 85004-2203

COUNT: \_\_\_\_\_ \$ \_\_\_\_\_ INT: \_\_\_\_\_  
FOR OFFICIAL USE ONLY

THE CLAIMS ARE SITUATED IN YAVAPAI COUNTY, AZ.

BLM SERIAL NUMBERS NAMES OF CLAIMS OR SITES

AMC 352160 THRU AMC \_\_\_\_\_ MUSTANG \_\_\_\_\_.

COUNTY BOOK/ DOCKET 3656 PAGE OR FEE NO 528 \_\_\_\_\_.

BLM SERIAL NUMBERS NAME OF CLAIM SITE COUNTY/BOOK/DOCKET & PAGE OR FEE NUMBER

AMC 352160 . MUSTANG . 3656 PG 528 .

AMC \_\_\_\_\_ . \_\_\_\_\_ . \_\_\_\_\_ .

AMC \_\_\_\_\_ . \_\_\_\_\_ . \_\_\_\_\_ .

CLAIMANT'S NAME: PAUL CLARK \_\_\_\_\_.

ADDRESS; PO. BOX 1308 CITY; CONGRESS STATE; AZ \_\_\_\_\_.

PHONE; 928-427-9503 ZIP; 85332 \_\_\_\_\_.

\_\_\_\_ CHECK HERE IF THIS IS A CHANGE OF ADDRESS;

SIGNATURE; Paul Clark \_\_\_\_\_.

TO RECORD WITH THE COUNTY, ONE CLAIMANT OR AGENT MUST SIGN.

LIST ALL ADDITIONAL OWNERS ON BACK SIDE OF THIS FORM  
FOR OFFICIAL USE ONLY

ENTERED INTO COMPUTER; \_\_\_\_\_.  
DATE INITIAL VERIFIED

RECEIVED  
BUREAU OF  
LAND MANAGEMENT  
2000 AUG 23 P 1:12  
TIME STAMP  
ARIZONA  
STATE OFFICE  
PHOENIX, ARIZONA

United States Department of the Interior  
 Bureau of Land Management  
 BUSINESS & SUPPORT SVCS DIV  
 ONE N CENTRAL AVE  
 PHOENIX, AZ 85004 -2203  
 Phone: (602) 417-9200

Receipt

No:

1342368

Transaction #: 1387600		<b>ENTERED INTO COMPUTER</b> SEP 05 2006 PB
Date of Transaction: 08/24/2006		
CUSTOMER:	PAUL CLARK PO BOX 1308 CONGRESS, AZ 85332	

LINE #	QTY	DESCRIPTION	REMARKS	UNIT PRICE	TOTAL
1	1.00	LOCATABLE MINERALS / MINING CLAIMS-NOT NEW-UNADJUD, ONE AUTH NO. ONLY / MINING CLAIM MONEY RECEIVED (455) CASES: AMC352160/\$125.00	MAINT 2007 (1)	- n/a -	125.00
<b>TOTAL:</b>					<b>\$125.00</b>

PAYMENT INFORMATION					
1	AMOUNT:	\$125.00	POSTMARKED:	08/21/2006	
	TYPE:	CHECK	RECEIVED:	08/23/2006	
	CHECK NO:	114			
	NAME:	CLARK, PAUL PO BOX 1308 CONGRESS AZ 85332			

REMARKS

This receipt was generated by the automated BLM Collections and Billing System and is a paper representation of a portion of the official electronic record contained therein.



**United States Department of the Interior**  
**Bureau of Land Management**  
 BUSINESS & SUPPORT SVCS DIV  
 ONE N CENTRAL AVE  
 PHOENIX, AZ 85004 -2203  
 Phone: (602) 417-9200

Receipt

No: 1342368

<b>Transaction #:</b> 1387600	
<b>Date of Transaction:</b> 08/24/2006	
<b>CUSTOMER:</b>	PAUL CLARK PO BOX 1308 CONGRESS,AZ 85332

LINE #	QTY	DESCRIPTION	REMARKS	UNIT PRICE	TOTAL
1	1.00	LOCATABLE MINERALS / MINING CLAIMS-NOT NEW-UNADJUD,ONE AUTH NO. ONLY / MINING CLAIM MONEY RECEIVED (455) <b>CASES: AMC352160/\$125.00</b>	MAINT 2007 (1)	- n/a -	125.00
<b>TOTAL:</b>					<b>\$125.00</b>

PAYMENT INFORMATION						
1	<b>AMOUNT:</b>	\$125.00	<b>POSTMARKED:</b>	08/21/2006		
	<b>TYPE:</b>	CHECK	<b>RECEIVED:</b>	08/23/2006		
	<b>CHECK NO:</b>	114				
	<b>NAME:</b>	CLARK, PAUL PO BOX 1308 CONGRESS AZ 85332				

REMARKS

This receipt was generated by the automated BLM Collections and Billing System and is a paper representation of a portion of the official electronic record contained therein.

AMC 352160

# MAINTENANCE FEE PAYMENT

\$125.00 MAINTENANCE FEE PAYMENT DUE ON OR BEFORE AUGUST 31, 2005  
IN LIEU OF ASSESSMENT WORK FOR THE UPCOMING ASSESSMENT  
YEAR BEGINNING SEPTEMBER 1 OF THE YEAR NOTED ABOVE.

BUREAU OF LAND MANAGEMENT  
ARIZONA STATE OFFICE  
222 NORTH CENTRAL AVENUE  
PHOENIX, AZ 85004-2203

COUNT: 1 \$ 125 INT: 0  
FOR OFFICIAL USE ONLY

THE CLAIMS ARE SITUATED IN YAVAPAI COUNTY, AZ.

BLM SERIAL NUMBERS NAMES OF CLAIMS OR SITES

AMC 352160 THRU AMC MUSTANG

COUNTY BOOK/ DOCKET 3656 PAGE OR FEE NO 528

BLM SERIAL NUMBERS NAME OF CLAIM SITE COUNTY/BOOK/DOCKET & PAGE OR FEE NUMBER

AMC 352160 MUSTANG 3656 PG 528

AMC \_\_\_\_\_

AMC \_\_\_\_\_

CLAIMANT'S NAME: PAUL CLARK

ADDRESS; PO. BOX 1308 CITY; CONGRESS STATE; AZ.

PHONE; 928-427-9503 ZIP; 85332

\_\_\_ CHECK HERE IF THIS IS A CHANGE OF ADDRESS;

SIGNATURE; Paul Clark  
TO RECORD WITH THE COUNTY, ONE CLAIMANT OR AGENT MUST SIGN.

LIST ALL ADDITIONAL OWNERS ON BACK SIDE OF THIS FORM  
FOR OFFICIAL USE ONLY

ENTERED INTO COMPUTER; 9/6/05 RWE  
DATE INITIAL VERIFIED

TIME STAMP  
2005 AUG 22 P 1:04  
RECEIVED  
BUREAU OF  
LAND MANAGEMENT  
ARIZONA  
STATE OFFICE  
PHOENIX, ARIZONA

**United States Department of the Interior  
Bureau of Land Management**

BUSINESS & SUPPORT SVCS DIV  
222 N CENTRAL AVE  
PHOENIX, AZ 85004 -2203  
Phone: (602) 417-9200

Receipt	
No:	1137460

<b>Transaction #:</b> 1176608	
<b>Date of Transaction:</b> 08/25/2005	
<b>CUSTOMER:</b>	PAUL CLARK PO BOX 1308 CONGRESS,AZ 85332

LINE #	QTY	DESCRIPTION	REMARKS	UNIT PRICE	TOTAL
1	1.00	LOCATABLE MINERALS / MINING CLAIMS-NOT NEW-UNADJUD,ONE AUTH NO. ONLY / MINING CLAIM MONEY RECEIVED (455) <b>CASES:</b> AMC352160/\$125.00	MAINT 2006 - 1	- n/a -	125.00
<b>TOTAL:</b>					<b>\$125.00</b>

PAYMENT INFORMATION			
1	AMOUNT:	\$125.00	POSTMARKED: 08/19/2005
	TYPE:	CHECK	RECEIVED: 08/22/2005
	CHECK NO:	92651071555	
	NAME:	CLARK, PAUL PO BOX 1308 CONGRESS AZ 85332	

REMARKS

This receipt was generated by the automated BLM Collections and Billing System and is a paper representation of a portion of the official electronic record contained therein.



352160

# MAINTENANCE FEE PAYMENT

\$100.00 MAINTENANCE FEE PAYMENT DUE ON OR BEFORE AUGUST 31, 2004  
IN LIEU OF ASSESSMENT WORK FOR THE UPCOMING ASSESSMENT  
YEAR BEGINNING SEPTEMBER 1 OF THE YEAR NOTED ABOVE.

BUREAU OF LAND MANAGEMENT  
ARIZONA STATE OFFICE  
222 NORTH CENTRAL AVENUE  
PHOENIX, AZ 85004-2203

COUNT; 1 \$ 125 INT: SC  
**FOR OFFICIAL USE ONLY**

THE CLAIMS ARE SITUATED IN Yavapai COUNTY, AZ.

**BLM SERIAL NUMBERS**

**NAMES OF CLAIMS OR SITES**

AMC 352160 THRU AMC \_\_\_\_\_

Mustang

COUNTY BOOK/ DOCKET 3656 PAGE(s) OR FEE NO(s) 528

**BLM SERIAL NUMBERS**

**NAME OF CLAIMS/SITES**

**COUNTY/ BOOK /DOCKET  
& PAGE OR FEE NUMBER**

AMC 352160

Mustang

3656 pg 528

AMC \_\_\_\_\_

\_\_\_\_\_

\_\_\_\_\_

AMC \_\_\_\_\_

\_\_\_\_\_

\_\_\_\_\_

CLAIMANT'S NAME; Paul Clark

ADDRESS; P.O. Box 1308 CITY; Congress STATE; AZ.

PHONE; 928-427-9503 ZIP; 85332

CHECK HERE IF THIS IS A CHANGE OF ADDRESS;

SIGNATURE; Paul Clark

To record with the county, one claimant or the agent must sign.

LIST ALL ADDITIONAL OWNERS ON BACK SIDE OF THIS FORM

**FOR OFFICIAL USE ONLY**  
ENTERED INTO COMPUTER: 9/29/04 K  
DATE INITIALS VERIFIED

**TIME STAMP**  
RECEIVED  
BUREAU OF  
LAND MANAGEMENT  
2004 AUG 31 A 9:46  
ARIZONA  
STATE OFFICE  
PHOENIX, ARIZONA



Paul Clark  
PO. Box 1308  
Congress AZ, 85332-1308

RECEIVED  
BUREAU OF  
LAND MANAGEMENT

2004 AUG 31 A 9:40

ARIZONA  
STATE OFFICE  
PHOENIX, ARIZONA



**BUREAU OF LAND MANAGEMENT**  
**222 NORTH CENTRAL AVENUE**  
**PHOENIX, AZ 85004**

85004-22203



**United States Department of the Interior**  
**Bureau of Land Management**  
 BUSINESS & SUPPORT SVCS DIV  
 222 N CENTRAL AVE  
 PHOENIX, AZ 85004 -2203  
 Phone: (602) 417-9200

Receipt	
No:	946039

**Transaction #:** 980457  
**Date of Transaction:** 09/03/2004

<b>CUSTOMER:</b>	PAUL CLARK P O BOX 1308 CONGRESS,AZ 85332
------------------	---

LINE #	QTY	DESCRIPTION	REMARKS	UNIT PRICE	TOTAL
1	1.00	LOCATABLE MINERALS / MINING CLAIMS-NOT NEW-UNADJUD,ONE AUTH NO. ONLY / MINING CLAIM MONEY RECEIVED (455) <b>CASES: AMC352160/\$125.00</b>	MAINT 2005 (1)	- n/a -	125.00
<b>TOTAL:</b>					<b>\$125.00</b>

PAYMENT INFORMATION			
1	AMOUNT:	\$125.00	POSTMARKED: 08/28/2004
	TYPE:	CHECK	RECEIVED: 08/31/2004
	CHECK NO:	1203	
	NAME:	CLARK, PAUL P O BOX 1308 CONGRESS AZ 85332	

REMARKS

This receipt was generated by the automated BLM Collections and Billing System and is a paper representation of a portion of the official electronic record contained therein.

MAINTENANCE FEE PAYMENT

AMC 352160

\$100.00 MAINTENANCE FEE PAYMENT DUE ON OR BEFORE AUGUST 31, 2003  
IN LIEU OF ASSESSMENT WORK FOR THE UPCOMING ASSESSMENT  
YEAR BEGINNING SEPTEMBER 1 OF THE YEAR NOTED ABOVE.

BUREAU OF LAND MANAGEMENT  
ARIZONA STATE OFFICE  
222 NORTH CENTRAL AVENUE  
  
PHOENIX, AZ 85004-2203

COUNT: 1 \$ 100 INT: R  
**FOR OFFICIAL USE ONLY** ck 1091

THE CLAIMS ARE SITUATED IN YAVAPAI COUNTY, AZ.

BLM SERIAL NUMBERS

NAMES OF CLAIMS OR SITES

AMC 352160 THRU AMC \_\_\_\_\_ MUSTANG

COUNTY BOOK/ DOCKET bk 3656 PAGE(s) OR FEE NO(s) pg 528

BLM SERIAL NUMBERS	NAME OF CLAIMS/SITES	COUNTY/ BOOK /DOCKET & PAGE OR FEE NUMBER
AMC <u>352160</u>	<u>mustang</u>	<u>fee# 3140264</u>
AMC _____	_____	_____
AMC _____	_____	_____

CLAIMANT'S NAME; PAUL CLARK

ADDRESS; 10615 N. Eagle lane CITY; Fountain Hill STATE; AZ

PHONE(480) 816-0126 ZIP; 85268

CHECK HERE IF THIS IS A CHANGE OF ADDRESS;

SIGNATURE; Paul Clark

To record with the county, one claimant or the agent must sign.

LIST ALL ADDITIONAL OWNERS ON BACK SIDE OF THIS FORM  
FOR OFFICIAL USE ONLY

ENTERED INTO COMPUTER; 8/21/03 RWE  
DATE INITIALS VERIFIED

RECEIVED  
BUREAU OF LAND MANAGEMENT  
2003 AUG 12 A 10: 09  
ARIZONA STATE OFFICE  
PHOENIX, ARIZONA

✓  
[Signature]

**United States Department of the Interior  
Bureau of Land Management**

BUSINESS & SUPPORT SVCS DIV  
222 N CENTRAL AVE  
PHOENIX, AZ 85004 -2203  
Phone: (602) 417-9200

Receipt

No:

728316

**Transaction #:** 757677**Date of Transaction:** 08/12/2003

**CUSTOMER:** PAUL CLARK  
10615 N EAGLE LN  
FOUNTAIN HILLS, AZ 85268

LINE #	QTY	DESCRIPTION	REMARKS	UNIT PRICE	TOTAL
1	1.00	LOCATABLE MINERALS / MINING CLAIMS-NOT NEW-UNADJUD, ONE AUTH NO. ONLY / MINING CLAIM MONEY RECEIVED (455) <b>CASES:</b> AMC352160/\$100.00	MAINT 2004 (1)	- n/a -	100.00
<b>TOTAL:</b>					<b>\$100.00</b>

## PAYMENT INFORMATION

1	AMOUNT:	\$100.00	POSTMARKED:	N/A
	TYPE:	CHECK	RECEIVED:	08/12/2003
	CHECK NO:	1091		
	NAME:	CLARK, PAUL 10615 N EAGLE LN FOUNTAIN HILLS AZ 85268		

## REMARKS

This receipt was generated by the automated BLM Collections and Billing System and is a paper representation of a portion of the official electronic record contained therein.



Receipt No. 544413

LEAD FILE #'S \_\_\_\_\_

Trans No. 569047

AMC 352160

AMC 352949

AMC Number	Code	Amount
<u>352160</u>	<u>482</u>	<u>100-</u>
<u>352949-352950</u>	<u>"</u>	<u>200</u>
TOTAL:		<u>\$ 300</u>

AMC Number	Code	Amount
TOTAL:		\$

Date of Doc \_\_\_\_\_

Date Entered: 9/27/02 PKH

Date of Rec't \_\_\_\_\_

Date Verified: \_\_\_\_\_

Amount Rec'd 300

Sent to Accts: 10/18/02

Amount Earned 300

Date Earned: \_\_\_\_\_

- 480 POL
- 481 NOI
- 482 MAINT
- 396 TRANS
- 635 AMEND

NOTES: \_\_\_\_\_

## MAINTENANCE FEE PAYMENT

\$100.00 MAINTENANCE FEE PAYMENT DUE ON OR BEFORE AUGUST 31, 2002  
 IN LIEU OF ASSESSMENT WORK FOR THE UPCOMING ASSESSMENT  
 YEAR BEGINNING SEPTEMBER 1 OF THE YEAR NOTED ABOVE.

**BUREAU OF LAND MANAGEMENT  
 ARIZONA STATE OFFICE  
 222 NORTH CENTRAL AVENUE  
 PHOENIX, AZ 85004-2203**

COUNT: 3 \$ 300 INT: cell  
**FOR OFFICIAL USE ONLY**

THE CLAIMS ARE SITUATED IN Yavapai COUNTY,  
 ARIZONA.

**BLM SERIAL NUMBERS** **NAMES OF CLAIMS OR SITES**

A MC \_\_\_\_\_ THRU A MC \_\_\_\_\_

COUNTY BOOK/DOCKET \_\_\_\_\_, PAGE(S) OR FEE NO(S) \_\_\_\_\_

A MC \_\_\_\_\_ THRU A MC \_\_\_\_\_

COUNTY BOOK/DOCKET \_\_\_\_\_, PAGE(S) OR FEE NO(S) \_\_\_\_\_

(OR) IF NOT CONSECUTIVE NUMBERS LIST SEPARATELY BELOW:

BLM SERIAL NUMBERS	NAME OF CLAIMS/SITES	COUNTY BOOK/DOCKET & PAGE OR FEE NUMBER	
A MC <u>352160</u>	<u>mustang</u> <u>3140264</u>	<u>BK 3656 PG 528</u>	
A MC <u>352950</u>	<u>kenai #1</u>		
A MC <u>352949</u>	<u>kenai #2</u> <u>3198000</u>	<u>BK 3704 PG 869</u>	
A MC _____	_____	_____	_____
A MC _____	_____	_____	_____
A MC _____	_____	_____	_____
A MC _____	_____	_____	_____
A MC _____	_____	_____	_____
A MC _____	_____	_____	_____
A MC _____	_____	_____	_____

CLAIMANT'S NAME: Paul Clark

ADDRESS: PO Box 750 CITY: vernon STATE: AZ

CHECK HERE IF THIS IS A CHANGE OF ADDRESS PHONE: (928) 521 1104 ZIP: 85940

SIGNATURE: Paul Clark  
 TO RECORD WITH THE COUNTY, ONE CLAIMANT OR THE AGENT MUST SIGN

LIST ALL ADDITIONAL OWNERS ON REVERSE SIDE OF THIS FORM

**FOR OFFICIAL USE ONLY**

ENTERED INTO COMPUTER: 9/27/02 DC  
 DATE INITIALS VERIFIED

TIME STAMP

2002 AUG 20 A 10:23

ARIZONA  
 STATE OFFICE  
 PHOENIX, ARIZONA

BUREAU OF  
 LAND MANAGEMENT

43 CFR 3833.0-5(e) (August 30, 1994) REQUIRES THAT THE NAMES OF ALL OF THE OWNERS AND THEIR CURRENT ADDRESSES SHALL BE IDENTIFIED ON ALL INSTRUMENTS REQUIRED TO BE RECORDED OR FILED BY THE REGULATIONS, 43 CFR SUBPART 3833.

CLAIMANT'S NAME: \_\_\_\_\_

ADDRESS: \_\_\_\_\_ CITY: \_\_\_\_\_ STATE: \_\_\_\_\_

CHECK HERE IF THIS IS CHANGE OF ADDRESS      PHONE: (     )      ZIP: \_\_\_\_\_

CLAIMANT'S NAME: \_\_\_\_\_

ADDRESS: \_\_\_\_\_ CITY: \_\_\_\_\_ STATE: \_\_\_\_\_

CHECK HERE IF THIS IS CHANGE OF ADDRESS      PHONE: (     )      ZIP: \_\_\_\_\_

CLAIMANT'S NAME: \_\_\_\_\_

ADDRESS: \_\_\_\_\_ CITY: \_\_\_\_\_ STATE: \_\_\_\_\_

CHECK HERE IF THIS IS CHANGE OF ADDRESS      PHONE: (     )      ZIP: \_\_\_\_\_

CLAIMANT'S NAME: \_\_\_\_\_

ADDRESS: \_\_\_\_\_ CITY: \_\_\_\_\_ STATE: \_\_\_\_\_

CHECK HERE IF THIS IS CHANGE OF ADDRESS      PHONE: (     )      ZIP: \_\_\_\_\_

CLAIMANT'S NAME: \_\_\_\_\_

ADDRESS: \_\_\_\_\_ CITY: \_\_\_\_\_ STATE: \_\_\_\_\_

CHECK HERE IF THIS IS CHANGE OF ADDRESS      PHONE: (     )      ZIP: \_\_\_\_\_

CLAIMANT'S NAME: \_\_\_\_\_

ADDRESS: \_\_\_\_\_ CITY: \_\_\_\_\_ STATE: \_\_\_\_\_

CHECK HERE IF THIS IS CHANGE OF ADDRESS      PHONE: (     )      ZIP: \_\_\_\_\_

CLAIMANT'S NAME: \_\_\_\_\_

ADDRESS: \_\_\_\_\_ CITY: \_\_\_\_\_ STATE: \_\_\_\_\_

CHECK HERE IF THIS IS CHANGE OF ADDRESS      PHONE: (     )      ZIP: \_\_\_\_\_

**United States Department of the Interior**  
**Bureau of Land Management**  
 BUSINESS & SUPPORT SVCS DIV  
 222 N CENTRAL AVE  
 PHOENIX, AZ 85004 -2203  
 Phone: (602) 417-9200

Receipt	
No:	544413

<b>Transaction #:</b> 569047
<b>Date of Transaction:</b> 08/20/2002
<b>CUSTOMER:</b> PAUL CLARK PO BOX 750 VERNON, AZ 85940

LINE #	QTY	DESCRIPTION	REMARKS	UNIT PRICE	TOTAL
1	1.00	LOCATABLE MINERALS / MINING CLAIMS-NOT NEW-UNADJUD, ONE AUTH NO. ONLY / MINING CLAIM MONEY RECEIVED (455) <b>CASES:</b> AMC352160/\$300.00	MAINT 2003 93)	- n/a -	300.00
<b>TOTAL:</b>					<b>\$300.00</b>

PAYMENT INFORMATION		
1	AMOUNT: \$300.00	POSTMARKED: 08/16/2002
	TYPE: CHECK	RECEIVED: 08/20/2002
	CHECK NO: 90905183280	
	NAME: CLARK, PAUL PO BOX 750 VERNON AZ 85940	

REMARKS

This receipt was generated by the automated BLM Collections and Billing System and is a paper representation of a portion of the official electronic record contained therein.





MAINTENANCE FEE PAYMENT

\$100.00 MAINTENANCE FEE PAYMENT DUE ON OR BEFORE AUGUST 31, ~~2001~~ 2001  
 IN LIEU OF ASSESSMENT WORK FOR THE UPCOMING ASSESSMENT  
 YEAR BEGINNING SEPTEMBER 1 OF THE YEAR NOTED ABOVE.

BUREAU OF LAND MANAGEMENT  
 ARIZONA STATE OFFICE  
 3707 NORTH 7TH STREET  
 PHOENIX, AZ 85014 (OR)  
 P.O. BOX 16563, PHOENIX, AZ 85011

COUNT: <u>5</u>	\$ <u>500</u>	INT: <u>C</u>
FOR OFFICIAL USE ONLY		

THE CLAIMS ARE SITUATED IN Yavapai COUNTY, ARIZONA.

BLM SERIAL NUMBERS \_\_\_\_\_ NAMES OF CLAIMS OR SITES \_\_\_\_\_  
 A MC \_\_\_\_\_ THRU A MC \_\_\_\_\_  
 COUNTY BOOK/DOCKET \_\_\_\_\_, PAGE(S) OR FEE NO(S) \_\_\_\_\_  
 A MC \_\_\_\_\_ THRU A MC \_\_\_\_\_  
 COUNTY BOOK/DOCKET \_\_\_\_\_, PAGE(S) OR FEE NO(S) \_\_\_\_\_

(OR) IF NOT CONSECUTIVE NUMBERS LIST SEPARATELY BELOW:

BLM SERIAL NUMBERS	NAME OF CLAIMS/SITES	COUNTY BOOK/DOCKET & PAGE OR FEE NUMBER
A MC <u>353534</u>	<u>P&amp;R #1</u>	<u>3246758</u> <u>3744 BK 981 PG</u>
A MC <u>353535</u>	<u>P&amp;R #2</u>	<u>3246759</u> <u>3744 BK 982 PG</u>
A MC <u>352160</u>	<u>MUSTANG</u>	<u>3140264</u> <u>3656 BK 528 PG</u>
A MC <u>352950</u>	<u>Kenai #1</u>	<u>3148000</u> <u>3704BK 869 PG</u>
A MC <u>352949</u>	<u>Kenai #2</u>	<u>3704BK 869 PG</u>
A MC _____	_____	_____
A MC _____	_____	_____
A MC _____	_____	_____
A MC _____	_____	_____
A MC _____	_____	_____

CLAIMANT'S NAME: Paul CLARK  
 ADDRESS: PO Box 750 CITY: Vernon STATE: AZ

CHECK HERE IF THIS IS A CHANGE OF ADDRESS PHONE: (520) 521-1104 cell ZIP: 85940

SIGNATURE: Paul Clark  
 TO RECORD WITH THE COUNTY, ONE CLAIMANT OR THE AGENT MUST SIGN

LIST ALL ADDITIONAL OWNERS ON REVERSE SIDE OF THIS FORM

FOR OFFICIAL USE ONLY		
ENTERED INTO COMPUTER: <u>10/9/01</u>	<u>TK</u>	_____
DATE	INITIALS	VERIFIED

TIME STAMP: 2001 AUG 20 10:51  
 RECEIVED  
 BUREAU OF LAND MANAGEMENT

43 CFR 3833.0-5(e) (August 30, 1994) REQUIRES THAT THE NAMES OF ALL OF THE OWNERS AND THEIR CURRENT ADDRESSES SHALL BE IDENTIFIED ON ALL INSTRUMENTS REQUIRED TO BE RECORDED OR FILED BY THE REGULATIONS, 43 CFR SUBPART 3833.

CLAIMANT'S NAME: PAUL CLARK  
ADDRESS: PO BOX 750 CITY: Vernon STATE: AZ  
 CHECK HERE IF THIS IS CHANGE OF ADDRESS PHONE: (520) 521 1104 cell ZIP: 85940

CLAIMANT'S NAME: Ronald W. Irvine  
ADDRESS: 7619 N 40<sup>th</sup> Dr CITY: Phoenix STATE: AZ  
 CHECK HERE IF THIS IS CHANGE OF ADDRESS PHONE: (623) 934-1967 ZIP: 85051

CLAIMANT'S NAME: \_\_\_\_\_  
ADDRESS: \_\_\_\_\_ CITY: \_\_\_\_\_ STATE: \_\_\_\_\_  
 CHECK HERE IF THIS IS CHANGE OF ADDRESS PHONE: ( ) ZIP: \_\_\_\_\_

CLAIMANT'S NAME: \_\_\_\_\_  
ADDRESS: \_\_\_\_\_ CITY: \_\_\_\_\_ STATE: \_\_\_\_\_  
 CHECK HERE IF THIS IS CHANGE OF ADDRESS PHONE: ( ) ZIP: \_\_\_\_\_

CLAIMANT'S NAME: \_\_\_\_\_  
ADDRESS: \_\_\_\_\_ CITY: \_\_\_\_\_ STATE: \_\_\_\_\_  
 CHECK HERE IF THIS IS CHANGE OF ADDRESS PHONE: ( ) ZIP: \_\_\_\_\_

CLAIMANT'S NAME: \_\_\_\_\_  
ADDRESS: \_\_\_\_\_ CITY: \_\_\_\_\_ STATE: \_\_\_\_\_  
 CHECK HERE IF THIS IS CHANGE OF ADDRESS PHONE: ( ) ZIP: \_\_\_\_\_

CLAIMANT'S NAME: \_\_\_\_\_  
ADDRESS: \_\_\_\_\_ CITY: \_\_\_\_\_ STATE: \_\_\_\_\_  
 CHECK HERE IF THIS IS CHANGE OF ADDRESS PHONE: ( ) ZIP: \_\_\_\_\_

**United States Department of the Interior**  
**Bureau of Land Management**  
 BUSINESS & SUPPORT SVCS DIV  
 222 N CENTRAL AVE  
 PHOENIX, AZ 85004 -2203  
 Phone: (602) 417-9200

Receipt	
No:	360799

Transaction #: 379342  
 Date of Transaction: 08/20/2001

CUSTOMER: PAUL CLARK  
 PO BOX 750  
 VERNON, AZ 85940

LINE #	QTY	COMMODITY / SUBJECT / ACTION / PRODUCT	REMARKS	UNIT PRICE	TOTAL
1	1.00	LOCATABLE MINERALS / MINING CLAIMS-NOT NEW-UNADJUD, ONE AUTH NO. ONLY / MINING CLAIM MONEY RECEIVED (455)	MAINT 2002 (5)	- n/a -	\$500.00
<b>TOTAL:</b>					<b>\$500.00</b>

PAYMENT INFORMATION			
1	AMOUNT:	\$500.00	POSTMARKED: 08/14/2001
	TYPE:	CHECK	RECEIVED: 08/20/2001
	CHECK NO:	1450	
	NAME:	CLARK, FAITH PO BOX 750 VERNON AZ 85940	

REMARKS

PHONE: SEE DOC.

CASE SERIAL NUMBER INFORMATION		
TRNS #	LINE #	CASES
379342	1	AMC353534/\$500.00

This receipt was generated by the automated BLM Collections and Billings System and is a paper representation of a portion of the official electronic record contained therein.



**SENDER: COMPLETE THIS SECTION**

- Complete items 1, 2, and 3. Also complete item 4 if Restricted Delivery is desired.
- Print your name and address on the reverse so that we can return the card to you.
- Attach this card to the back of the mailpiece, or on the front if space permits.

1. Article Addressed to:

**Paul Clark**  
**P.O. Box 750**  
**Vernon, AZ 85940**  
 (957) MH AMC 352160

2. Article Number (Copy from service label)

*Notices / Plans returned  
 to Paul Clark*

**COMPLETE THIS SECTION ON DELIVERY**

A. Received by (Please Print Clearly)

*Paul Clark*

B. Date of Delivery

*12/17/08*

C. Signature

*X Paul Clark* Agent Addressee

D. Is delivery address different from item 1?

 Yes

If YES, enter delivery address below:

 No

3. Service Type

 Certified Mail Express Mail Registered Return Receipt for Merchandise Insured Mail C.O.D.

4. Restricted Delivery? (Extra Fee)

 Yes

UNITED STATES POSTAL SERVICE

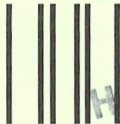
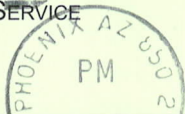

HAPPY  
"WHO-LIDAYS"  
from the

First-Class Mail  
Postage & Fees Paid  
USPS  
Permit No. G-10

• Sender: Please print your name, address, and ZIP+4 in this box. •

Bureau of ~~and~~ Management  
AZ State Office  
222 N. Central Ave - 1<sup>st</sup> Floor  
Phoenix, AZ 85004-2202

ARIZONA  
STATE OFFICE  
PHOENIX, ARIZONA

2001 JAN - 8 A 10: 22

RECEIVED  
BUREAU OF  
LAND MANAGEMENT



Receipt #: 176641

Lead #: 352160-352949-353534

Amount Received: 500.-

Date: 8-25-00

Transaction #: 189881

AMC #	Code	\$\$\$\$\$
352160	482	100.-
352949-352950	11	200.-
353534-353535	11	200.-

AMC #	Code	\$\$\$\$\$

Total: 500.-

- 480----POL-----\$5
- 481----NOI-----\$5
- 482----Maint.---\$100
- 396----Trf.-----\$5
- 635----Amd.-----\$5
- 379----Refund

Entered: *So* 8-29-00  
Date

Verified: *AS* AUG 31 2000  
Date

Sent to Accounts:   AUG 31 2000  
Date

Earned by Accounts:    
Date

**MAINTENANCE FEE PAYMENT**

**\$100.00 MAINTENANCE FEE PAYMENT DUE ON OR BEFORE AUGUST 31, 19\_\_\_\_  
IN LIEU OF ASSESSMENT WORK FOR THE UPCOMING ASSESSMENT  
YEAR BEGINNING SEPTEMBER 1 OF THE YEAR NOTED ABOVE.**

BUREAU OF LAND MANAGEMENT  
ARIZONA STATE OFFICE  
3707 NORTH 7TH STREET  
PHOENIX, AZ 85014 (OR)  
P.O. BOX 16563, PHOENIX, AZ 85011

COUNT: 5 \$ 500 INT: C  
**FOR OFFICIAL USE ONLY**

THE CLAIMS ARE SITUATED IN YAVAPAI COUNTY,  
ARIZONA.

**BLM SERIAL NUMBERS** **NAMES OF CLAIMS OR SITES**

A MC \_\_\_\_\_ THRU A MC \_\_\_\_\_

COUNTY BOOK/DOCKET \_\_\_\_\_, PAGE(S) OR FEE NO(S) \_\_\_\_\_

A MC \_\_\_\_\_ THRU A MC \_\_\_\_\_

COUNTY BOOK/DOCKET \_\_\_\_\_, PAGE(S) OR FEE NO(S) \_\_\_\_\_

(OR) IF NOT CONSECUTIVE NUMBERS LIST SEPARATELY BELOW:

BLM SERIAL NUMBERS	NAME OF CLAIMS/SITES	COUNTY BOOK/DOCKET & PAGE OR FEE NUMBER
A MC <u>352160</u>	<u>mustang</u>	<u>BK 3656 PG 528</u>
A MC <u>352949</u>	<u>Kenai # 2</u>	<u>Don't Have</u>
A MC <u>352950</u>	<u>Kenai # 1</u>	<u>Don't Have</u>
A MC <u>353534</u>	<u>P&amp;R # 1</u>	<u>BK 3744 PG 981</u>
A MC <u>353535</u>	<u>P&amp;R # 2</u>	<u>BK 3744 PG 982</u>
A MC _____	_____	_____
A MC _____	_____	_____
A MC _____	_____	_____
A MC _____	_____	_____
A MC _____	_____	_____

CLAIMANT'S NAME: PAUL CLARK

ADDRESS: PO BOX 750 CITY: VERNON STATE: AZ

CHECK HERE IF THIS IS A CHANGE OF ADDRESS PHONE: (520) 521-1104 cell ZIP: 85970

SIGNATURE: Paul Clark  
TO RECORD WITH THE COUNTY, ONE CLAIMANT OR THE AGENT MUST SIGN

LIST ALL ADDITIONAL OWNERS ON REVERSE SIDE OF THIS FORM

**FOR OFFICIAL USE ONLY**

ENTERED INTO COMPUTER: 8-29-00 [Signature] AUG 31 2000  
DATE INITIALS VERIFIED

**TIME STAMP**

AUG 25 10 53 AM '00  
BLM LAND OFFICE  
PHOENIX, AZ



43 CFR 3833.0-5(e) (August 30, 1994) REQUIRES THAT THE NAMES OF ALL OF THE OWNERS AND THEIR CURRENT ADDRESSES SHALL BE IDENTIFIED ON ALL INSTRUMENTS REQUIRED TO BE RECORDED OR FILED BY THE REGULATIONS, 43 CFR SUBPART 3833.

CLAIMANT'S NAME: PAUL CIARK  
ADDRESS: PO BOX 750 CITY: Vernon STATE: AZ  
 CHECK HERE IF THIS IS CHANGE OF ADDRESS PHONE: (520) 521 1104 <sup>cell</sup> ZIP: 85970

CLAIMANT'S NAME: Ronald w. Irvine  
ADDRESS: 7619 N. 40<sup>w</sup> Dr CITY: Phoenix STATE: AZ  
 CHECK HERE IF THIS IS CHANGE OF ADDRESS PHONE: (602) 625 6584 <sup>mobile</sup> ZIP: 85051

CLAIMANT'S NAME: \_\_\_\_\_  
ADDRESS: \_\_\_\_\_ CITY: \_\_\_\_\_ STATE: \_\_\_\_\_  
 CHECK HERE IF THIS IS CHANGE OF ADDRESS PHONE: ( ) ZIP: \_\_\_\_\_

CLAIMANT'S NAME: \_\_\_\_\_  
ADDRESS: \_\_\_\_\_ CITY: \_\_\_\_\_ STATE: \_\_\_\_\_  
 CHECK HERE IF THIS IS CHANGE OF ADDRESS PHONE: ( ) ZIP: \_\_\_\_\_

CLAIMANT'S NAME: \_\_\_\_\_  
ADDRESS: \_\_\_\_\_ CITY: \_\_\_\_\_ STATE: \_\_\_\_\_  
 CHECK HERE IF THIS IS CHANGE OF ADDRESS PHONE: ( ) ZIP: \_\_\_\_\_

CLAIMANT'S NAME: \_\_\_\_\_  
ADDRESS: \_\_\_\_\_ CITY: \_\_\_\_\_ STATE: \_\_\_\_\_  
 CHECK HERE IF THIS IS CHANGE OF ADDRESS PHONE: ( ) ZIP: \_\_\_\_\_

CLAIMANT'S NAME: \_\_\_\_\_  
ADDRESS: \_\_\_\_\_ CITY: \_\_\_\_\_ STATE: \_\_\_\_\_  
 CHECK HERE IF THIS IS CHANGE OF ADDRESS PHONE: ( ) ZIP: \_\_\_\_\_

**United States Department of the Interior  
Bureau of Land Management**  
BUSINESS & SUPPORT SVCS DIV  
222 N CENTRAL AVE  
PHOENIX, AZ 85004 -2203  
Phone: (602) 417-9200

Receipt	
No:	176641

<b>Transaction #:</b> 189881					
<b>Date of Transaction:</b> 08/25/2000					
<b>CUSTOMER:</b>		PAUL CLARK PO BOX 750 VERNON,AZ 85940			
LINE #	QTY	COMMODITY / SUBJECT / ACTION / PRODUCT	REMARKS	UNIT PRICE	TOTAL
1	1	LOCATABLE MINERALS / MINING CLAIMS-ACCOUNTS/UNADJUDICATED / MINING CLAIM MONEY RECEIVED (455)	MAINT 2001 (5)	- n/a -	\$500.00
<b>TOTAL:</b>					<b>\$500.00</b>

PAYMENT INFORMATION			
1	AMOUNT:	\$500.00	POSTMARKED: 08/22/2000
	TYPE:	CHECK	RECEIVED: 08/25/2000
	CHECK NO:	1115	
	NAME:	CLARK, FAITH	

REMARKS

CASE SERIAL NUMBER INFORMATION		
TRNS #	LINE #	CASES
189881	1	AMC352160

This receipt was generated by the automated BLM Collections and Billings System and is a paper representation of a portion of the official electronic record contained therein.

## MAINTENANCE FEE PAYMENT

\$100.00 MAINTENANCE FEE PAYMENT DUE ON OR BEFORE AUGUST 31, 19 99  
 IN LIEU OF ASSESSMENT WORK FOR THE UPCOMING ASSESSMENT  
 YEAR BEGINNING SEPTEMBER 1 OF THE YEAR NOTED ABOVE.

**BUKEAU OF LAND MANAGEMENT  
 ARIZONA STATE OFFICE  
 222 NORTH CENTRAL AVENUE  
 PHOENIX, AZ 85004-2203**

**352160**

---

COUNT: 1 \$ 100.00 INT: Jmc  
**FOR OFFICIAL USE ONLY**

THE CLAIMS ARE SITUATED IN Yavapai COUNTY,  
 ARIZONA.

BLM SERIAL NUMBERS	NAMES OF CLAIMS OR SITES
A MC _____ THRU A MC _____	_____
COUNTY BOOK/DOCKET _____, PAGE(S) OR FEE NO(S) _____	_____
A MC _____ THRU A MC _____	_____
COUNTY BOOK/DOCKET _____, PAGE(S) OR FEE NO(S) _____	_____

(OR) IF NOT CONSECUTIVE NUMBERS LIST SEPARATELY BELOW:

BLM SERIAL NUMBERS	NAME OF CLAIMS/SITES	Fee #	COUNTY BOOK/DOCKET & PAGE OR FEE NUMBER
A MC <u>352160</u>	<u>MUSTANG</u>	<u>3140264</u>	<u>BK 3 656 P 6528</u>
A MC _____	_____	_____	_____
A MC _____	_____	_____	_____
A MC _____	_____	_____	_____
A MC _____	_____	_____	_____
A MC _____	_____	_____	_____
A MC _____	_____	_____	_____
A MC _____	_____	_____	_____
A MC _____	_____	_____	_____
A MC _____	_____	_____	_____

CLAIMANT'S NAME: PAUL CLARK  
 ADDRESS: PO Box 4950 CITY: MESA STATE: AZ

CHECK HERE IF THIS IS A CHANGE OF ADDRESS      PHONE: (480) 969-9307      ZIP: 85211-4950

SIGNATURE: Paul Clark  
 TO RECORD WITH THE COUNTY, ONE CLAIMANT OR THE AGENT MUST SIGN

LIST ALL ADDITIONAL OWNERS ON REVERSE SIDE OF THIS FORM

**FOR OFFICIAL USE ONLY**

ENTERED INTO COMPUTER: 9/16/99      SP      TK 10/18/99  
 DATE      INITIALS      VERIFIED

TIME STAMP

AUG 30 1999 11:59 AM

VERIFIED  
TK  
10-18-99



UNITED STATES  
DEPARTMENT OF THE INTERIOR  
BUREAU OF LAND MANAGEMENT

RECEIPT AND ACCOUNTING ADVICE

NO. 2297096 07

CD/AZ

08/31/99

Subject: CLAIM MAINTENANCE FEE 2000

2 14 13

100.00

Applicant:

CLARK AUTOMOTIVE REPAIR  
PO BOX 4950  
MESA AZ 85211

CK 1082

Remitter:

Assignor:

LEASE MANAGEMENT DATA										<input type="checkbox"/> NEW	<input type="checkbox"/> UPDATE	<input type="checkbox"/> PAYMENT
ORIGINAL SERIAL NO.	ASG.	TYPE	ST.	CTY.	FUND SYMBOL			ACRES/UNITS	RATE			
AMC 352160												
AMOUNT	ANV. DATE	EXP. DATE	BILL CYC.	S/C	DISTRICT	NEXT BILL	MISC. DATA	U of M	ACTUAL UNITS			
ASSIGNMENT SERIAL NO.	ASG.	TYPE	ST.	CTY.	FUND SYMBOL			ACRES/UNITS	RATE			
AMOUNT	ANV. DATE	EXP. DATE	BILL CYC.	S/C	DISTRICT	NEXT BILL	MISC. DATA	U of M	ACTUAL UNITS			
APPLY REMITTANCE										Remarks:       BY: _____ DATE: _____		
ACTION	FUND SYMBOL		CTY.	AMOUNT								
FILING FEE												
RENTAL												
UNEARNED												
REFUND												
TOTAL												
AMOUNT DUE												
<input type="checkbox"/> Lease in Escrow? <input type="checkbox"/> KGS?                      Of Interest? <input type="checkbox"/> Auto Escalates?            Operating Rights? <input type="checkbox"/> Auto Renew?                Operator Bond Filed?										<b>FOR MMS USE ONLY</b>		
					BILLEE			FOREST REFUGE				
					NUMBER							
					OCS SECTION							
					CODE							



**NOTICE!!**

**These documents have been scanned!**

**Do not place un-scanned documents beneath this notice!**

**Do not remove this notice from this file!**

GPO Jacket No. 560-102  
Print Order 61540  
Rise Business Services, LLC  
Job=AZ15 7/3/2019



Box Number= AZ15140



Claim Begin-End: AMC352160-AMC352160

**5 Miscellaneous**



AZ15140-6

AMC351599-AMC352455

**NO  
DOCUMENTS  
FOUND**

NO DOCUMENTS FOUND  
NO DOCUMENTS FOUND



**NOTICE!!**

**These documents have been scanned!**

**Do not place un-scanned documents beneath this notice!**

**Do not remove this notice from this file!**

GPO Jacket No. 560-102  
Print Order 61540  
Rise Business Services, LLC  
Job=AZ15 7/3/2019



Box Number= AZ15140



Claim Begin-End: AMC352160-AMC352160

**6 Location Notices-Amendments and Supporting Documents**



AZ15140-6 AMC351599-AMC352455

United States Department of the Interior  
BUREAU OF LAND MANAGEMENT  
ARIZONA STATE OFFICE  
222 North Central Avenue  
Phoenix, Arizona 85004-2203

June 22, 1999

In Reply Refer To:  
3800 (952.3)

CLAIMANT(S): Paul Clark  
P.O. Box 4950  
Mesa, Arizona 85031

The enclosed claim index is provided to identify the owner's name, address, and AMC number assigned to the claim(s). If the name and/or address is incorrect, please advise.

If you have any questions, please call Mining Claims Adjudication at (602) 417-9518.

Enclosure



**MINING CLAIM STATUS REPORT**

Status Checked By: _____
MTP Checked By: <u>6/11/99</u>
GEO Checked By: <u>2</u>
Preadjudication By: <u>2</u>
Final Adjudication By: <u>Antyle 6/16/99</u>

LEAD SERIAL NO. AMC 352160 THROUGH AMC \_\_\_\_\_

_____ 1	LODE	@ \$25 = \$	<u>25</u>	Location Fee
_____	PLACER	@ \$10 = \$	<u>10</u>	Service Fee--curable defect
_____	MILL SITE	@ \$100 = \$	<u>100</u>	Claim Maintenance Fee
_____	TUNNEL SITE	\$	<u>135</u>	<b>TOTAL FEES</b>
_____	ASSOCIATION	\$	<u>.39</u>	Copy Fees
_____	PLACER	\$	<u>135.39</u>	Overage <input type="checkbox"/> Shortage <input type="checkbox"/>
		\$		<b>TOTAL RECEIVED</b>

OVER-THE-COUNTER:  MAIL:  Timely Filed: YES  NO

**LEGAL DESCRIPTION:**

T <u>8N</u>	R <u>1W</u>	S <u>3</u>	T _____	R _____	S _____
T _____	R _____	S _____	T _____	R _____	S _____
T _____	R _____	S _____	T _____	R _____	S _____
T _____	R _____	S _____	T _____	R _____	S _____

GENERAL JURISDICTION: BLM  or NATIONAL FOREST  \_\_\_\_\_  
Name

SPLIT ESTATE LAND: SX  PX  SRHE  OTHER  N/A  
Specify

WILDERNESS AREA (WA): N/A  
Specify

CLAIMS SUBJECT TO PL 359: YES  NO

PROPER NOTICE FILED IF LOCATING ON SRHE: YES  NO

COMMENTS: \_\_\_\_\_  
\_\_\_\_\_  
\_\_\_\_\_  
\_\_\_\_\_

STATUS: PARTIALLY VOID  VOID

PRIVATE MINERALS  WITHDRAWN  OTHER

COMMENTS: \_\_\_\_\_  
\_\_\_\_\_  
\_\_\_\_\_  
\_\_\_\_\_  
\_\_\_\_\_  
\_\_\_\_\_  
\_\_\_\_\_  
\_\_\_\_\_  
\_\_\_\_\_

Paul Clark  
P.O. Box 4950  
Mesa, AZ 85211-4950

3140 BK 3656 PG 528  
Yavapai County  
Patsy Jenney-Colon, Recorder  
04/20/1999 11:11A PAGE 1 OF 3  
PAUL CLARK  
RECORDING FEE 5.00  
SURCHARGE 4.00  
POSTAGE 0.00

### LOCATION NOTICE FOR LODE MINING CLAIM

NOTICE IS HEREBY GIVEN that the MUSTANG lode mining claim has been located by Paul Clark whose current mailing address is P.O. Box 4950, Mesa, Arizona 85211.

The general course of this claim is southeast to southwest and is situated in Yavapai County, Arizona.

This claim is 1500 feet in length and 500 feet in width. This southwest corner of the claim is approximately 750 feet in a southeast direction from the brass cap 1916 survey marker on the southeast corner of Township 8 North, Range 1 West, Section 3 and proceeds in a northwest direction 1500 feet then southwest 500 feet then southeast 1500 feet then northeast 500 feet ending at the point of beginning. This claim is marked by as location monuments, one at each corner of the claim.

This claim encompasses

- W 1/4, SE 1/4, SE 1/4, NE 1/4 of Township 8 North, Range 1 West, Section 3
- S 1/4, SE 1/4, SE 1/4, NE 1/4, of Township 8 North, Range 1 West, Section 3
- E 1/4, NW 1/4, NW 1/4, SE 1/4 of Township 8 North, Range 1 West, Section 3
- E 1/4, NW 1/4, NW 1/4, SE 1/4 of Township 8 North, Range 1 West, Section 3
- W 1/4, NW 1/4, NW 1/4, SE 1/4 of Township 8 North, Range 1 West, Section 3
- NE 1/4, SW 1/4, NW 1/4, SE 1/4 of Township 8 North, Range 1 West, Section 3
- SE 1/4, SW 1/4, NW 1/4, SE 1/4 of Township 8 North, Range 1 West, Section 3
- NE 1/4, SW 1/4, SE 1/4 of Township 8 North, Range 1 West, Section 3
- NE 1/4, SE 1/4, SW 1/4, SE 1/4 of Township 8 North, Range 1 West, Section 3
- NW 1/4, SW 1/4, SE 1/4, SE 1/4 of Township 8 North, Range 1 West, Section 3
- NW 1/4, SE 1/4, SE 1/4 of Township 8 North, Range 1 West, Section 3
- W 1/4, SW 1/4, NE 1/4, SE 1/4 of Township 8 North, Range 1 West, Section 3
- S 1/4, SW 1/4, NE 1/4, SE 1/4 of Township 8 North, Range 1 West, Section 3

NE  
SE  
MAY 18 10 22 AM '99  
RECEIVED  
BUREAU OF  
LAND MANAGEMENT  
ARIZONA  
STATE OFFICE  
PHOENIX, ARIZONA  
5/11/99

RECEIVED  
B.L.M. AZ STATE OFFICE  
1999 MAY 27 A 11: 25  
PHOENIX, ARIZONA

W 1/4, NW 1/4, NE 1/4, SE 1/4 of Township 8 North, Range 1 West, Section 3

DATED AND POSTED on this ground this 04 day of 01 1999.

April 01 1999

LOCATOR

Paul Clark

Paul Clark

AMERICAN  
STATE OFFICE  
PHOENIX, ARIZONA

RECEIVED  
BUREAU OF  
LAND MANAGEMENT  
MAY 27 11 05 AM '99

# LODE CLAIM MAP

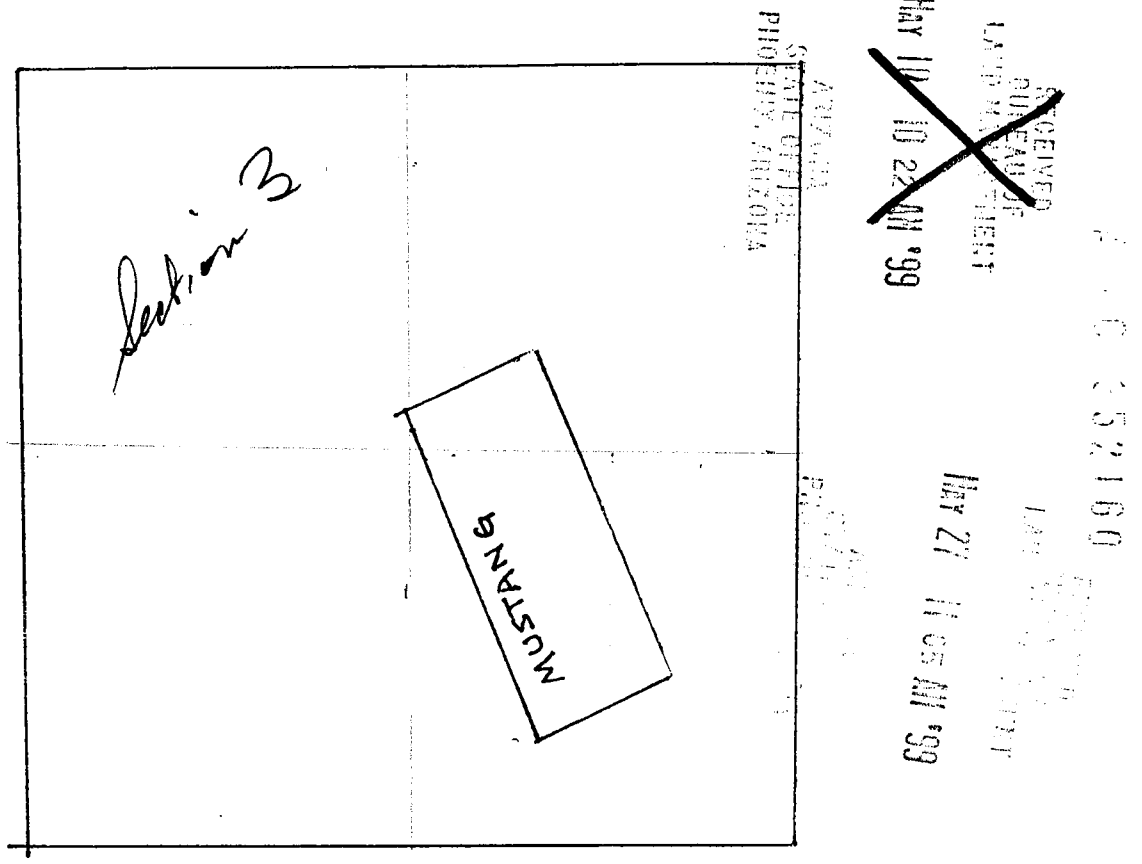

Scale : 1" = 1320 feet.

1. The above map depicts the MUSTANG mining claim, which is located in Section 3, Township 8 North, Range 1 West, Gila and Salt River Base and Meridian, Humbug Mining District, Yavapai County, Arizona.
2. The type of corner and location monuments used are white PVC pipes with orange, white and green stripes



Run Date: 06/08/1999  
RUN TIME:10:47 AM

UNITED STATES DEPARTMENT OF INTERIOR  
BUREAU OF LAND MANAGEMENT

Page: 1

STATE: AZ

GEOGRAPHIC REPORT WITH LAND

<u>CASETYPE</u>	<u>CASE DISP</u>	<u>MER</u>	<u>TWP</u>	<u>RNG</u>	<u>SECT</u>	<u>SUR TYP</u>	<u>SUR NR</u>	<u>SUF</u>	<u>SUBDIVISION</u>
<b>Serial Number: AZA 025725</b>									
<b>Total Case Acres: 1.000</b>									
380913	AUTHORIZED	14	0080N	0010W	003	1		1	PART;
<b>Serial Number: AZA 029480</b>									
<b>Total Case Acres: 2.500</b>									
380913	AUTHORIZED	14	0080N	0010W	003	1		1	E2
<b>Serial Number: AZA 029486</b>									
<b>Total Case Acres: 2.500</b>									
380913	AUTHORIZED	14	0080N	0010W	003	1		1	ALL;
<b>Serial Number: AZA 030528</b>									
<b>Total Case Acres: 1.000</b>									
281001	PENDING	14	0080N	0010W	003	A			SWSW;

N/A

# BLM - New Mining Claims

Serial-No: AMC352160

Save

Clear

Void

**INFO:**

NEW MINING CLAIM HAS BEEN INSERTED SUCCESSFULLY!

## Case Header Details

Case Type	Claim Name	Commodity
384101	MUSTANG	

Lookup

## Owner Details

Proprietor Name	Address	City	State	Zip	Int Rel	Pct Int
CLARK PAUL	BOX 4950	MESA	AZ	85211	58	

[-] [X] [E]

Lookup

## Land Description Details

	Meridian	Twp	Range	Sec	NE	NW	SW	SE	GEO-CNTY	Dist/RA	Agency
1	14	0080N	0010W	003	X			X	AZ025	0200	21000000
2											
3											
4											
5											

[-] [X] [E]

Lookup

## Action Details

Date (mm/dd/yyyy)	Code	Action Taken	Action Remarks
04/01/1999	403	LOCATION DATE	
05/27/1999	395	RECORDATION NOTICE RECD	
05/27/1999	482		1999
05/27/1999	501		AMC352160
04/20/1999	404		0;3656;528
<input type="button" value="P"/> <input type="button" value="X"/> <input type="button" value="E"/>			

Top of Screen

AZ-1274-4  
(June 1987)

DEPARTMENT OF THE INTERIOR  
BUREAU OF LAND MANAGEMENT  
ARIZONA STATE OFFICE

EXAMINATION OF CASE FILE

A SEPARATE FORM MUST BE COMPLETED FOR EACH LEAD SERIAL NUMBER:

SERIAL NUMBER	TYPE OF CASE
352160	MINING CLAIM

I BILL WALDECK HAVE READ AND UNDERSTOOD THE WARNINGS RELATIVE TO TITLE 18 U.S.C. 1001 AND 2071 PRINTED ON THIS FORM AND REQUEST TO EXAMINE THE CASE RECORD BEARING THE ABOVE SERIAL NUMBER OR NAME. I AGREE NOT TO REMOVE OR ALTER THE CONTENTS OF THIS FILE IN ANY MANNER WHATSOEVER AND NOT TO REMOVE THE FILE FROM THE ROOM DESIGNATED FOR PUBLIC EXAMINATION OF SUCH RECORDS.

NAME: <u>BILL WALDECK</u>	DATE: <u>8-17-99</u>
ADDRESS: <u>NEW RIVER AZ</u>	

(PLEASE PRINT INCLUDING ZIP CODE)

\*\*\*\*\*

- WARNING -

Title 18 U.S. Code 1001. Statements or entries generally

Whoever, in any manner within the jurisdiction of any department or agency of the United States knowingly and willfully falsifies, conceals or covers up by any trick, scheme, or a device a material fact, or makes any false, fictitious or fraudulent statements or representations, or makes or uses any false writing or document knowing the same to contain any false, fictitious or fraudulent statement or entry, shall be fined not more than \$10,000 or imprisoned not more than five years, or both.

- Warning -

Title 18 U.S. Code 2071. Concealment, removal or mutilation generally

Whoever, willfully and unlawfully conceals, removes, mutilates, obliterates, or destroys, or attempts to do so, or, with intent to do so takes and carries away any record, proceeding, map book, paper, document, or other thing, filed or deposited with any clerk or officer of any court of the United States, or in any public office, or with any judicial or public officer of the United States, shall be fined not more than \$2,000 or imprisoned not more than three years.



# TOWNSHIP 8 NORTH RANGE 1 WEST OF THE GILA AND SALT RIVER MERIDIAN, ARIZONA

YAVAPAI COUNTY

STATUS OF PUBLIC DOMAIN  
LAND AND MINERAL TITLES

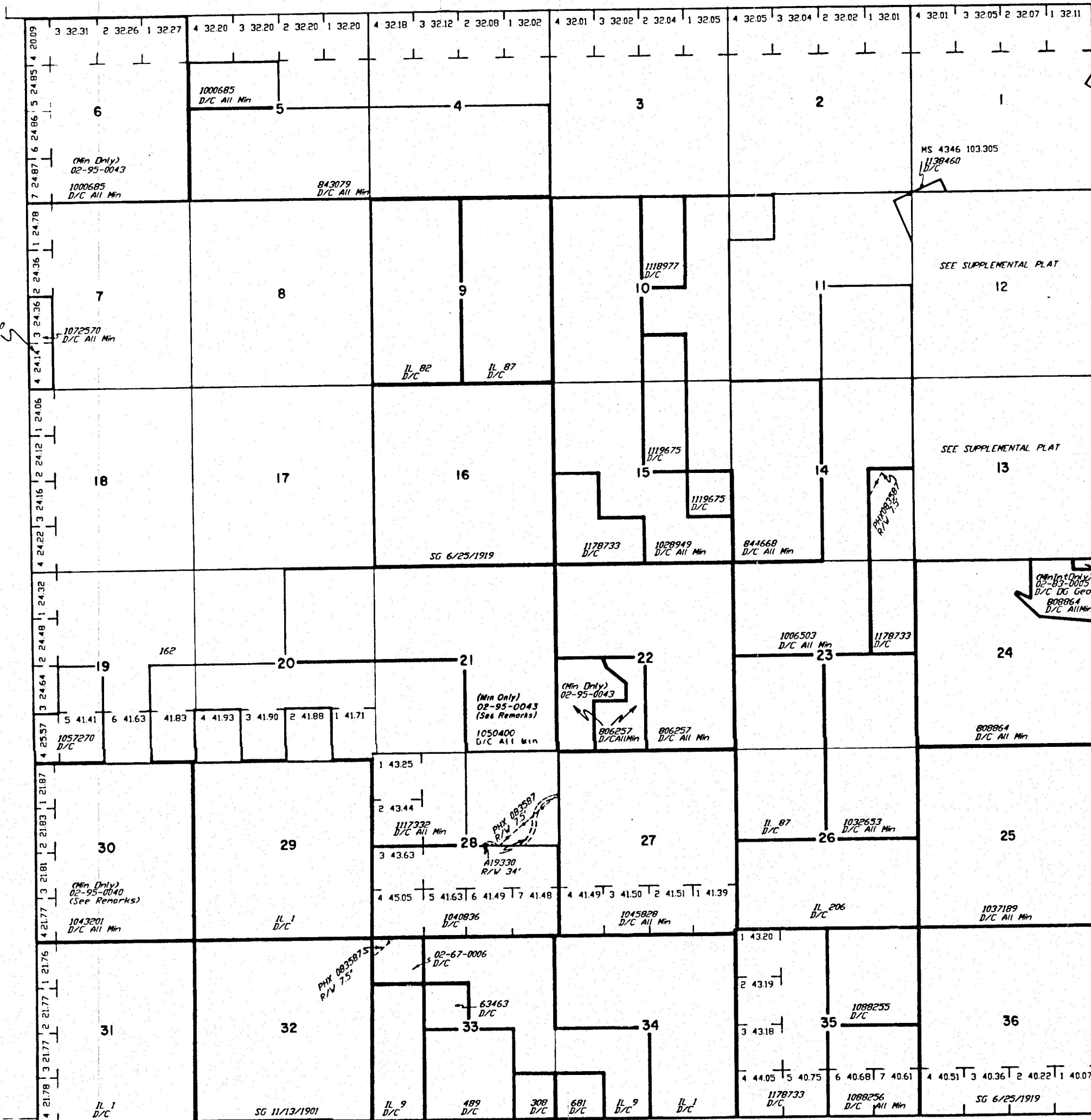

INDEX TO SEGREGATED TRACTS				
RESURVEY TRACT NO	ORIGINAL SURVEY			
	T	R	SEC	SUBDIVISION

FOR ORDERS EFFECTING DISPOSAL OF UNIDENTIFIED LANDS WITHDRAWN FOR CLASSIFICATION OF MINERALS, WATER AND/OR OTHER PUBLIC PURPOSES, REFER TO INDEX OF MISCELLANEOUS DOCUMENTS

DIST. NO. 2

GRAZING DIST. NO. 2

MDS 206 NE

02-95-0040 (Min Only)  
Sec 30-All that part Lot 1E1/2W1/2E1/2 lying north of a fence along the south of Buckhorn Wash and Castle Creek

02-95-0043 (Min Only)  
Sec 21-N1/2, SE1/4 less and excepting M&B in the NE1/4

RECEIVED  
E.L.M. STATE OFFICE  
PHOENIX, ARIZONA  
1999 JUL 12 A 8 39

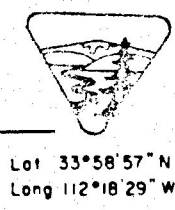

Lot 33° 58' 57" N  
Long 112° 18' 29" W

CURRENT TO	BY
9/12/1997	RE

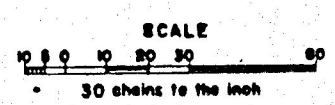

**WARNING STATEMENT**  
This plat is the Bureau's Record of Title, and should be used only as a graphic display of the township survey data. Records hereon do not reflect title changes which may have been effected by lateral movements of rivers or other bodies of water. Refer to the cadastral surveys for official survey information.